

HOBART

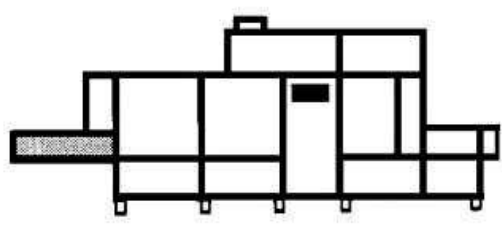

FTX



D-229 230-1 (x=799mm)
 D-229 230-2 (x=1085mm)

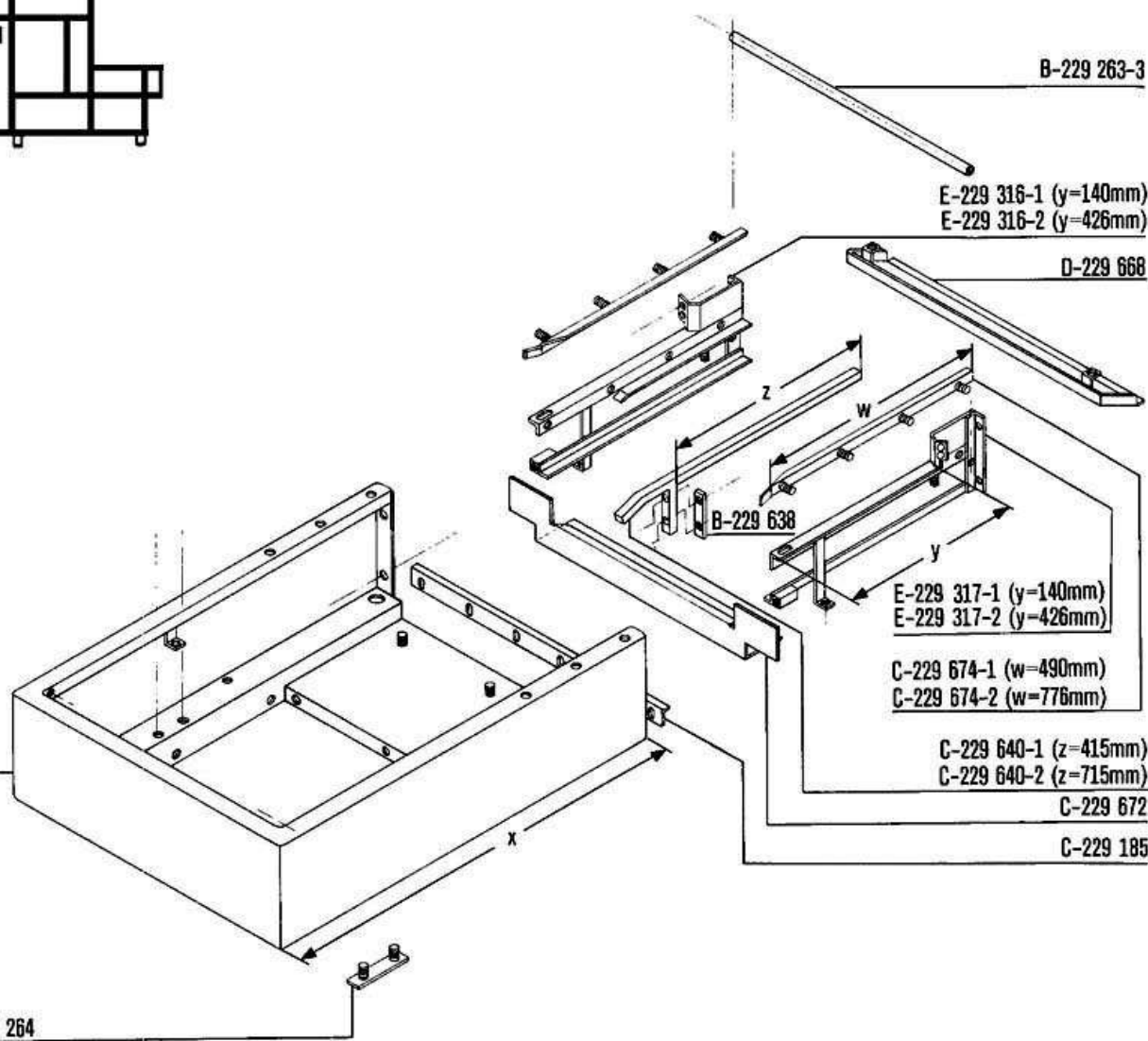

B-229 264

E-230 472

B-226 558

B-226 556

B-228 694-3

B-226 557

B-168 611-4

B-228 752

D-230 467-1 (v=296mm)

D-230 467-2 (v=582mm)

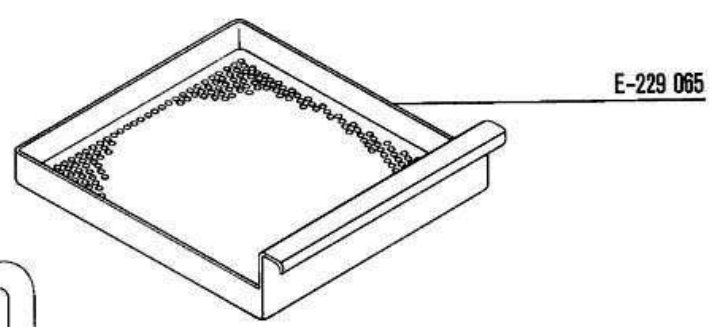

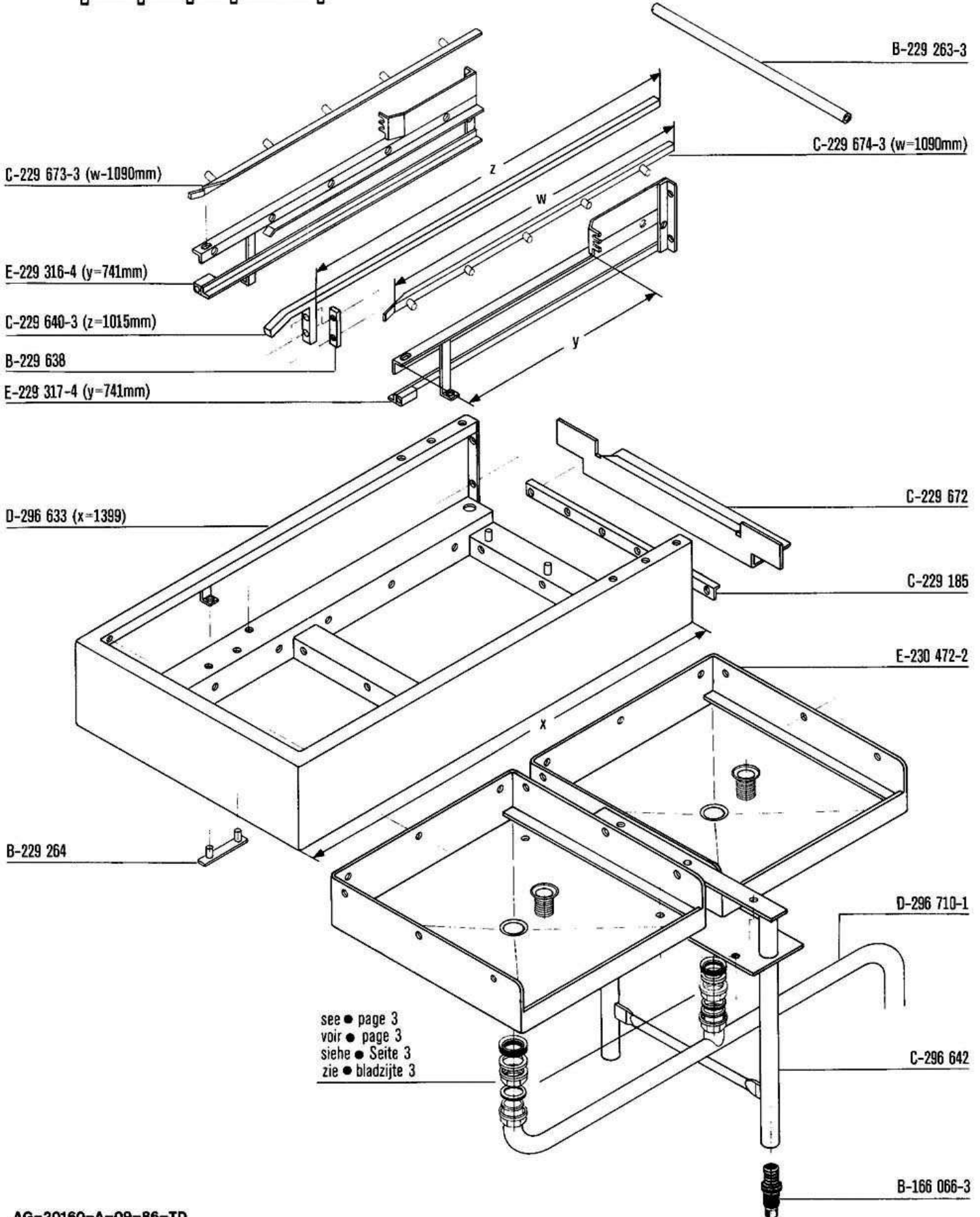
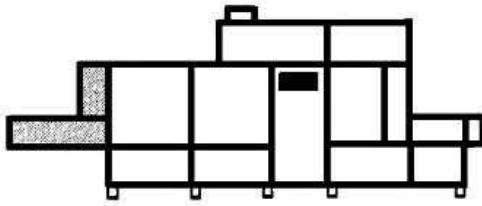

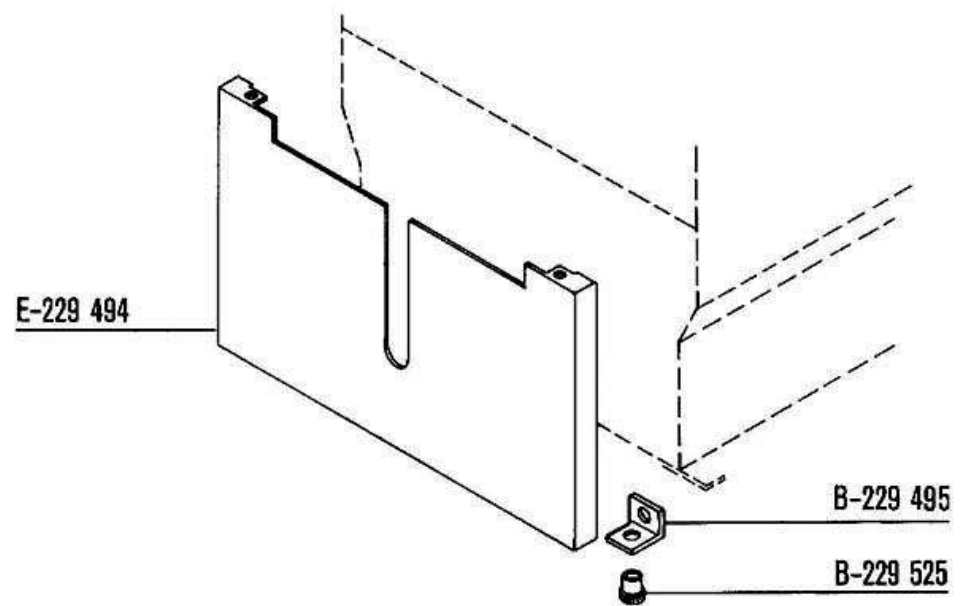
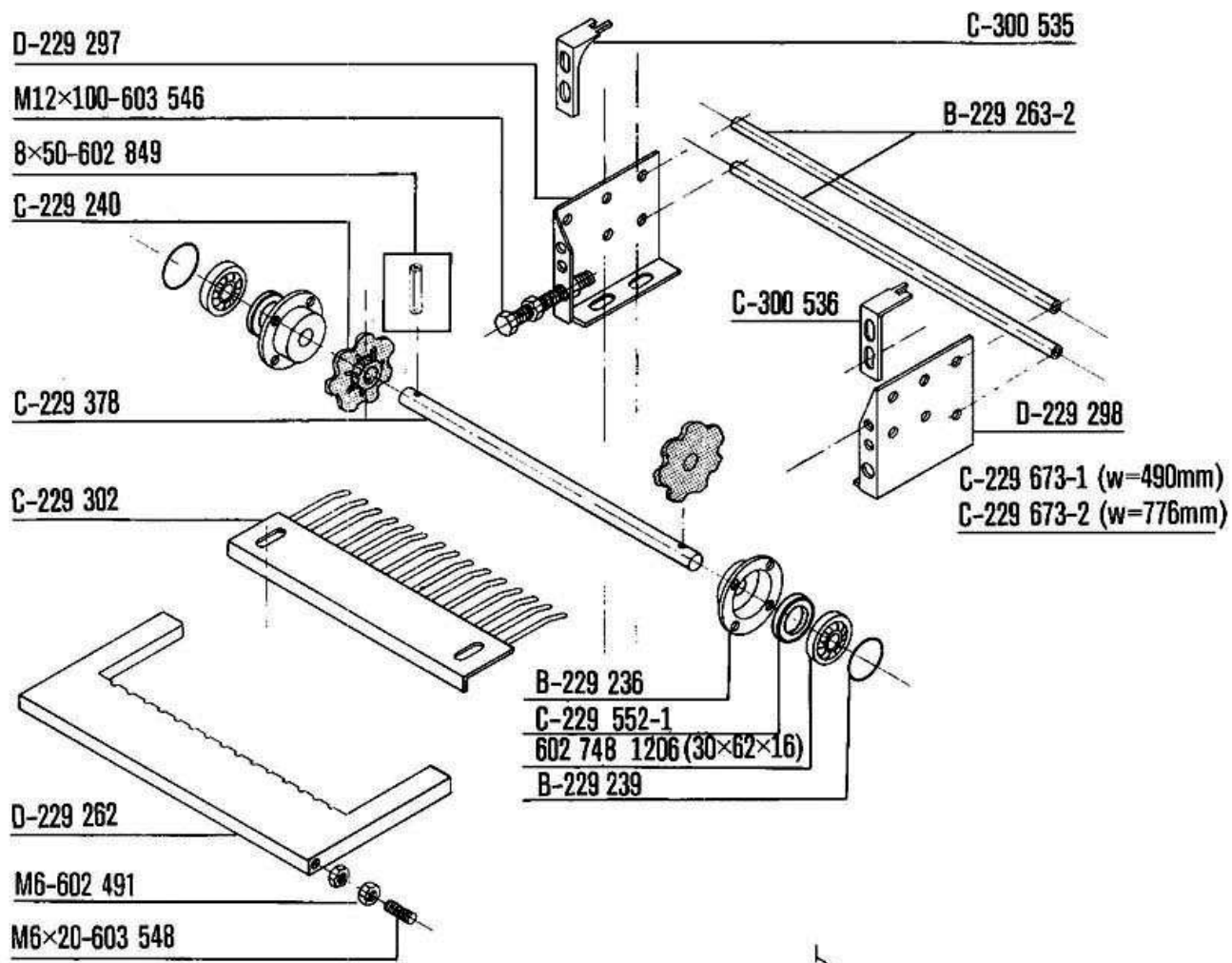
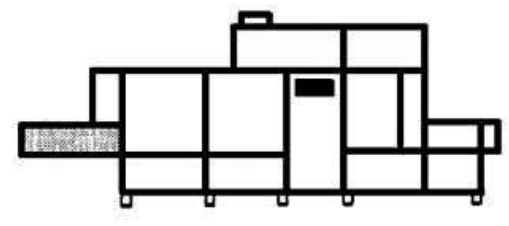

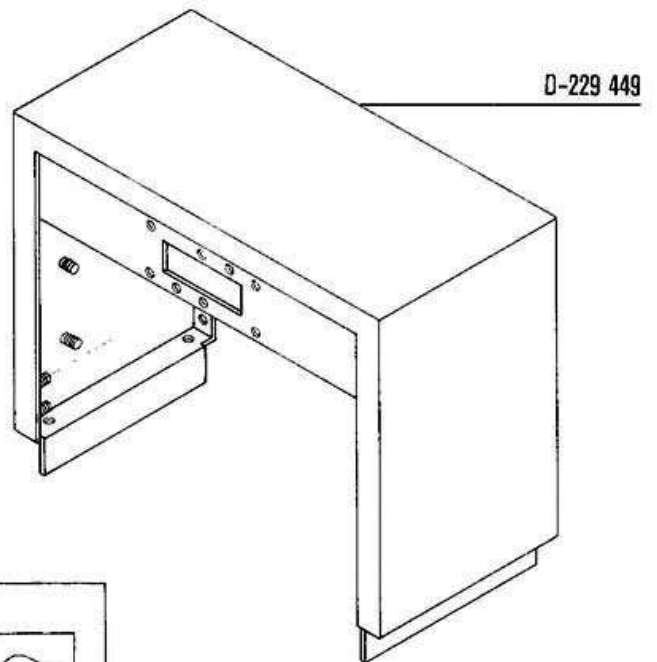
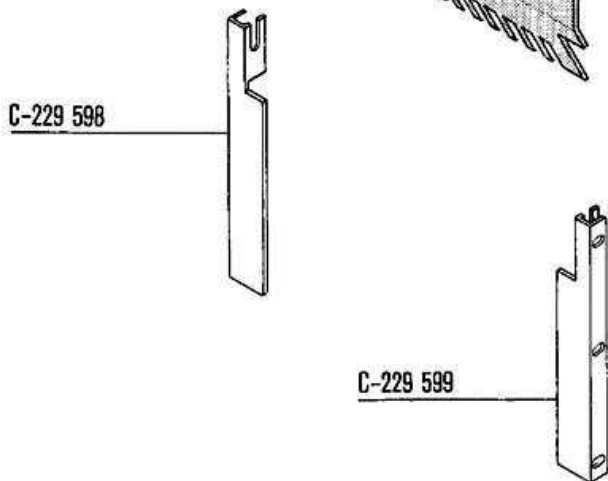
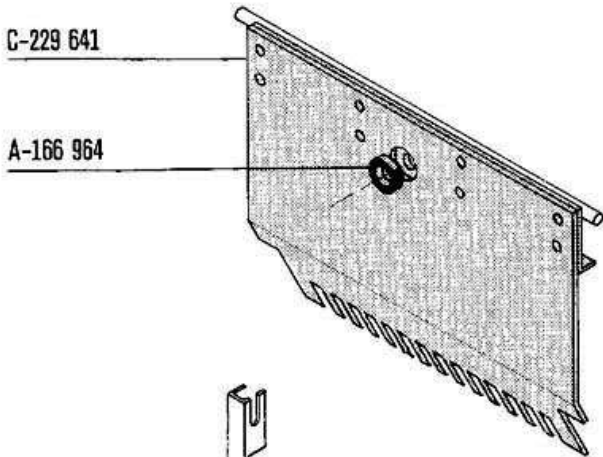
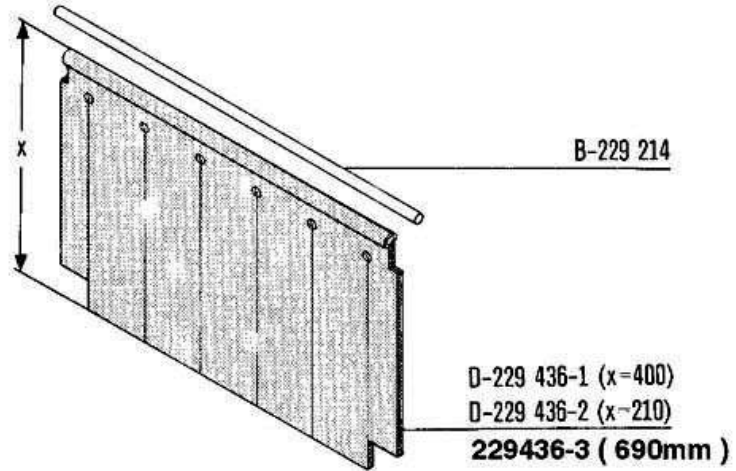
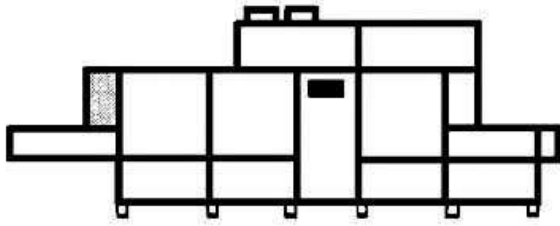

B-169 619-11

B-166 513-4

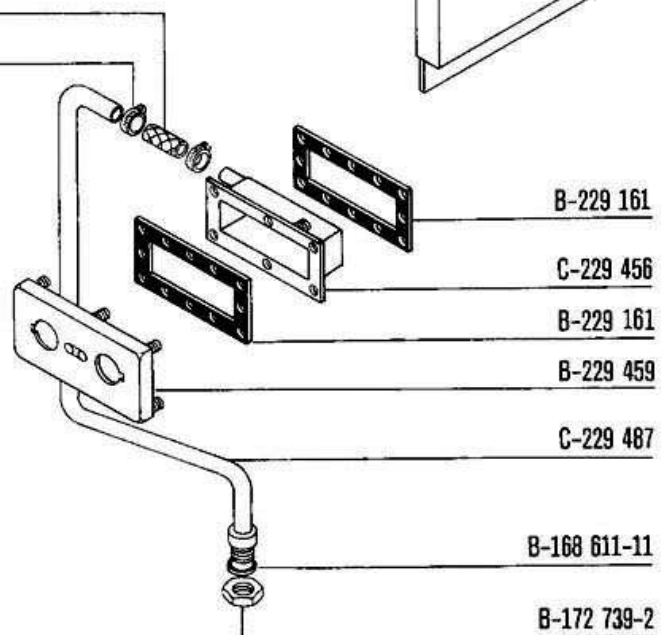

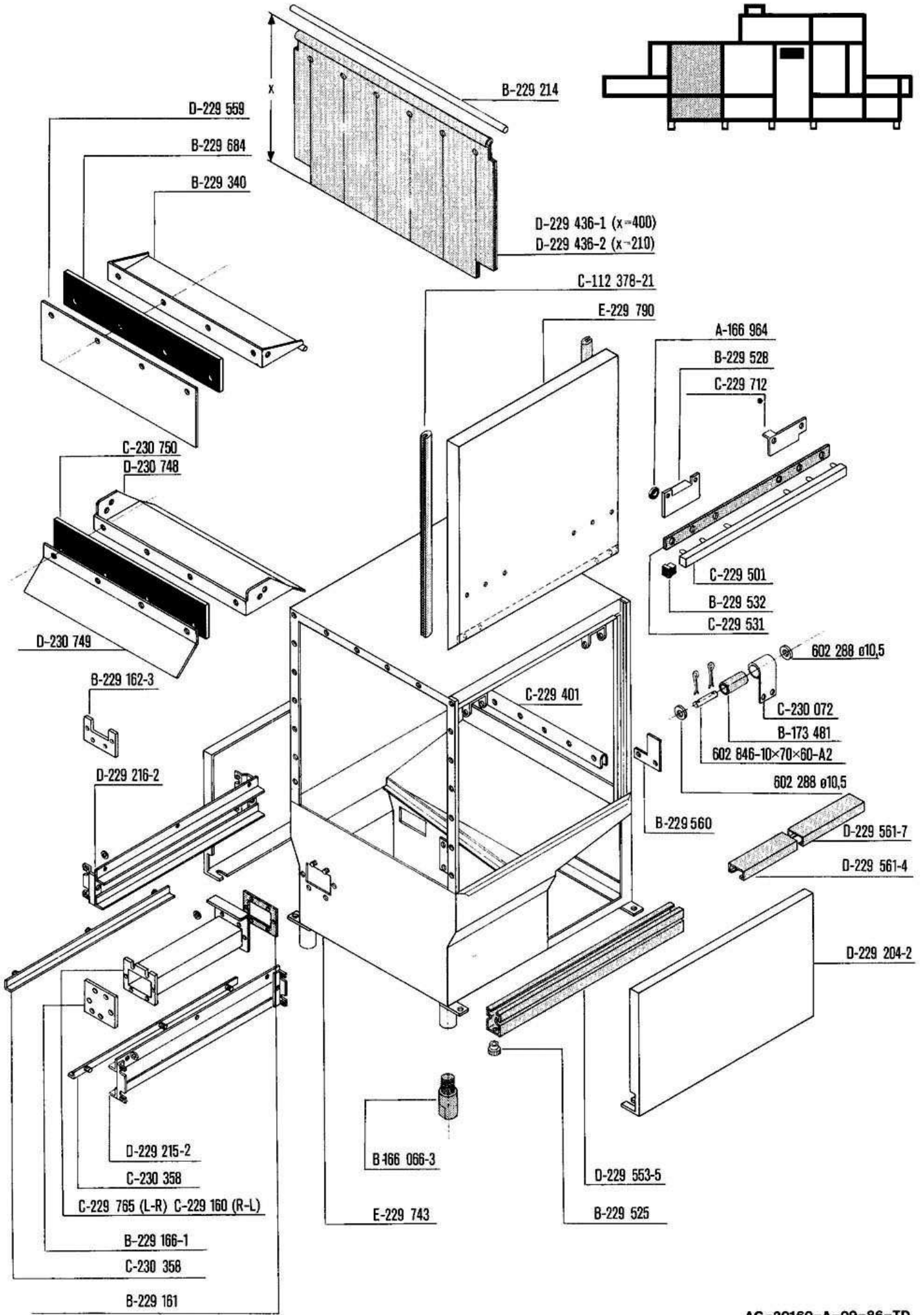

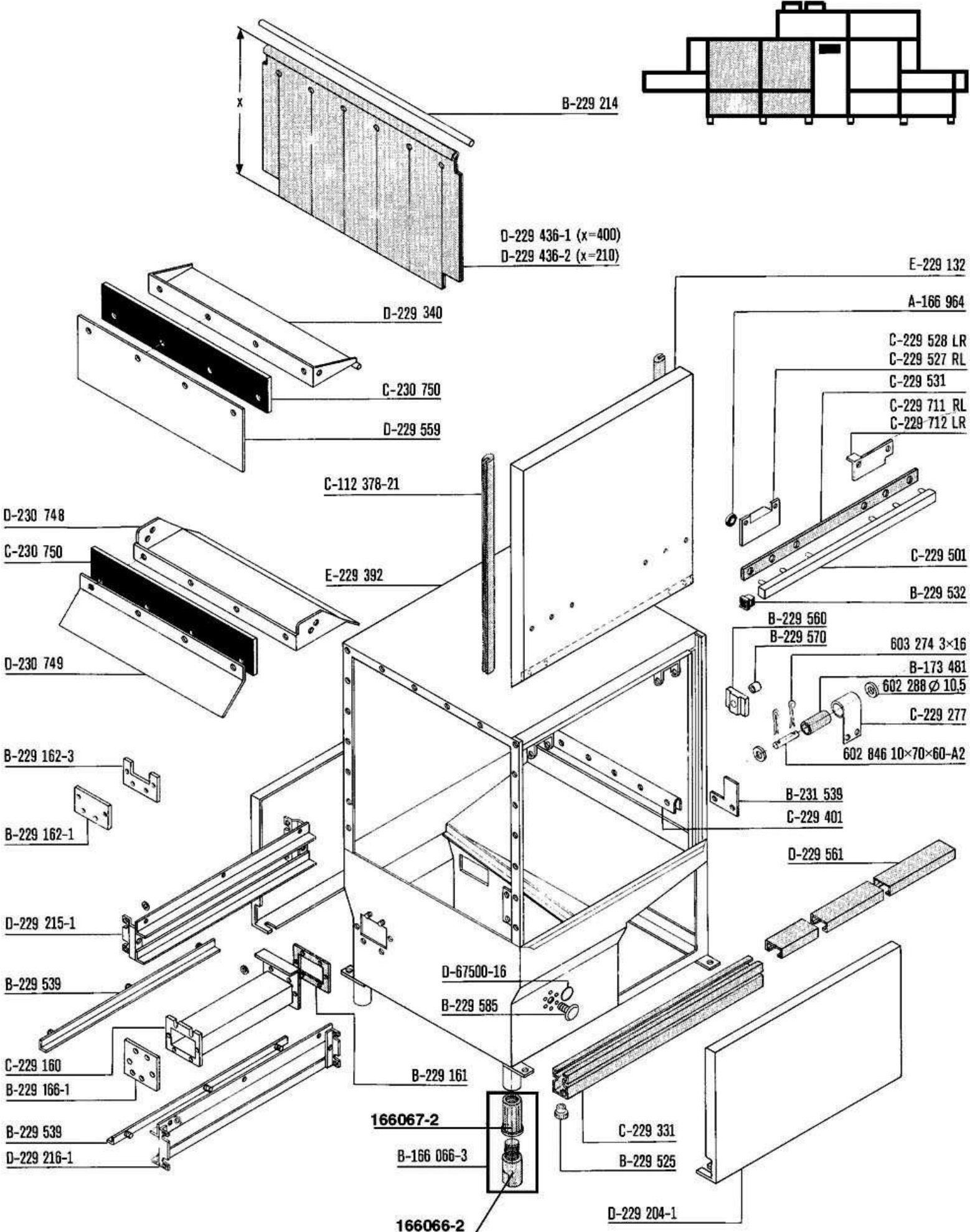

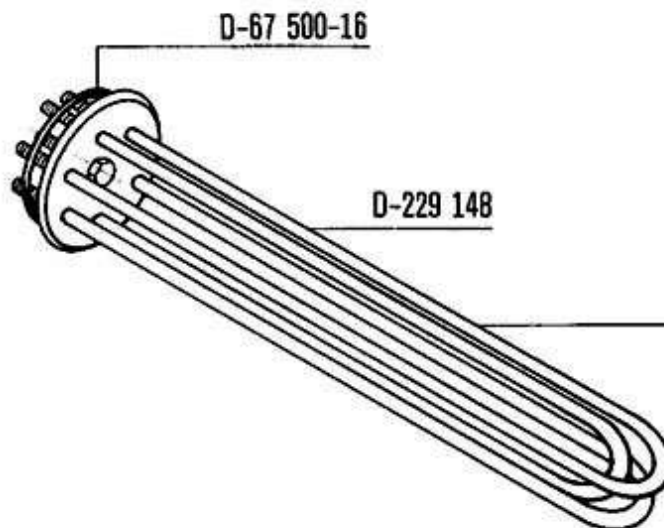
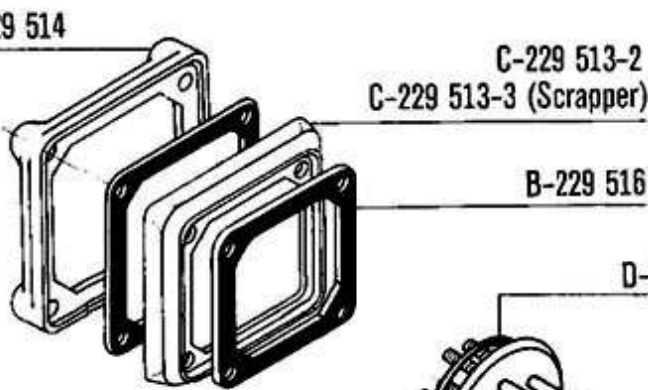
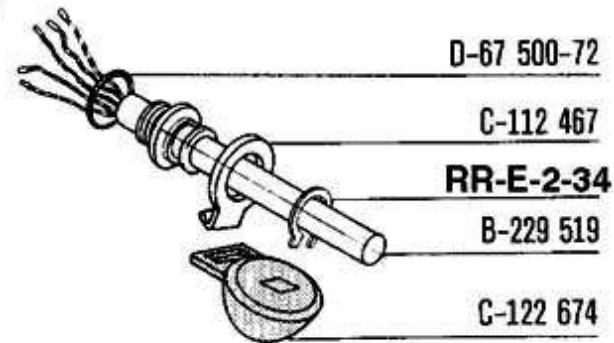
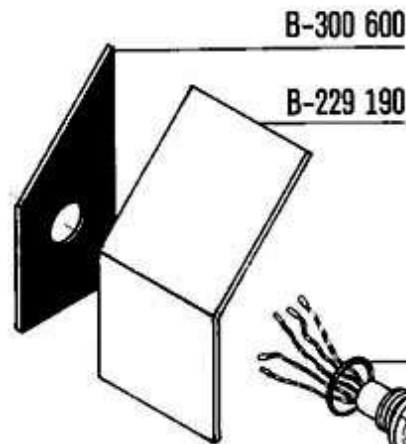
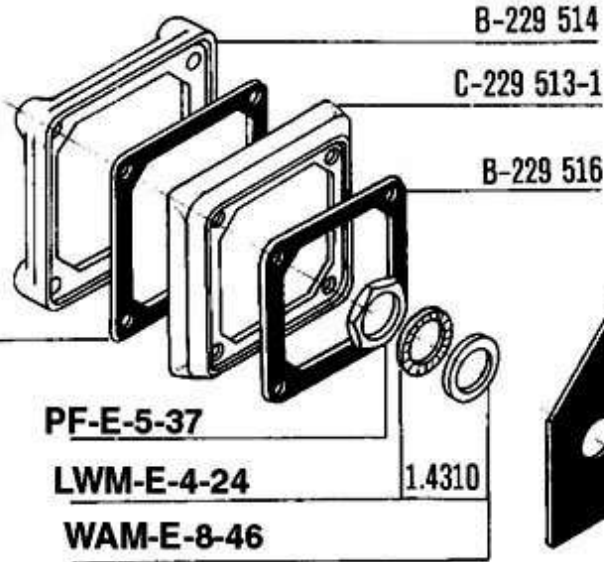
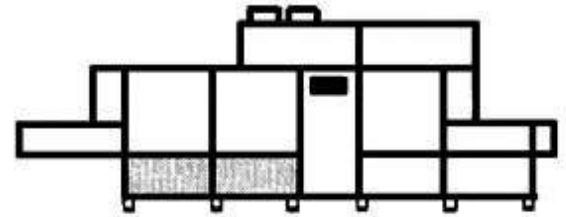

see wiring diagram
voir schéma de cablage
siehe Schaltplan
zie elektrisch schema



Tankheating-hot water + steam
 Chauffage du bac-eau chaud+vapeur
 Tankheizung-Heißwasser+Dampf
 Tankverwarming-heet water+stoom

FTX

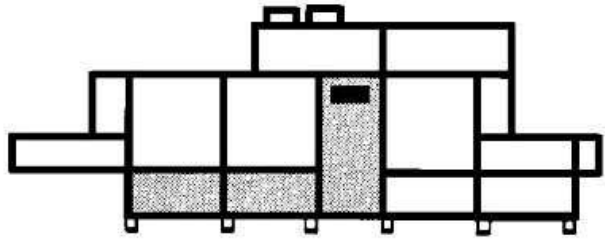

see wiring diagram
 voir schéma de cablage
 siehe Schaltplan
 zie elektrisch schema

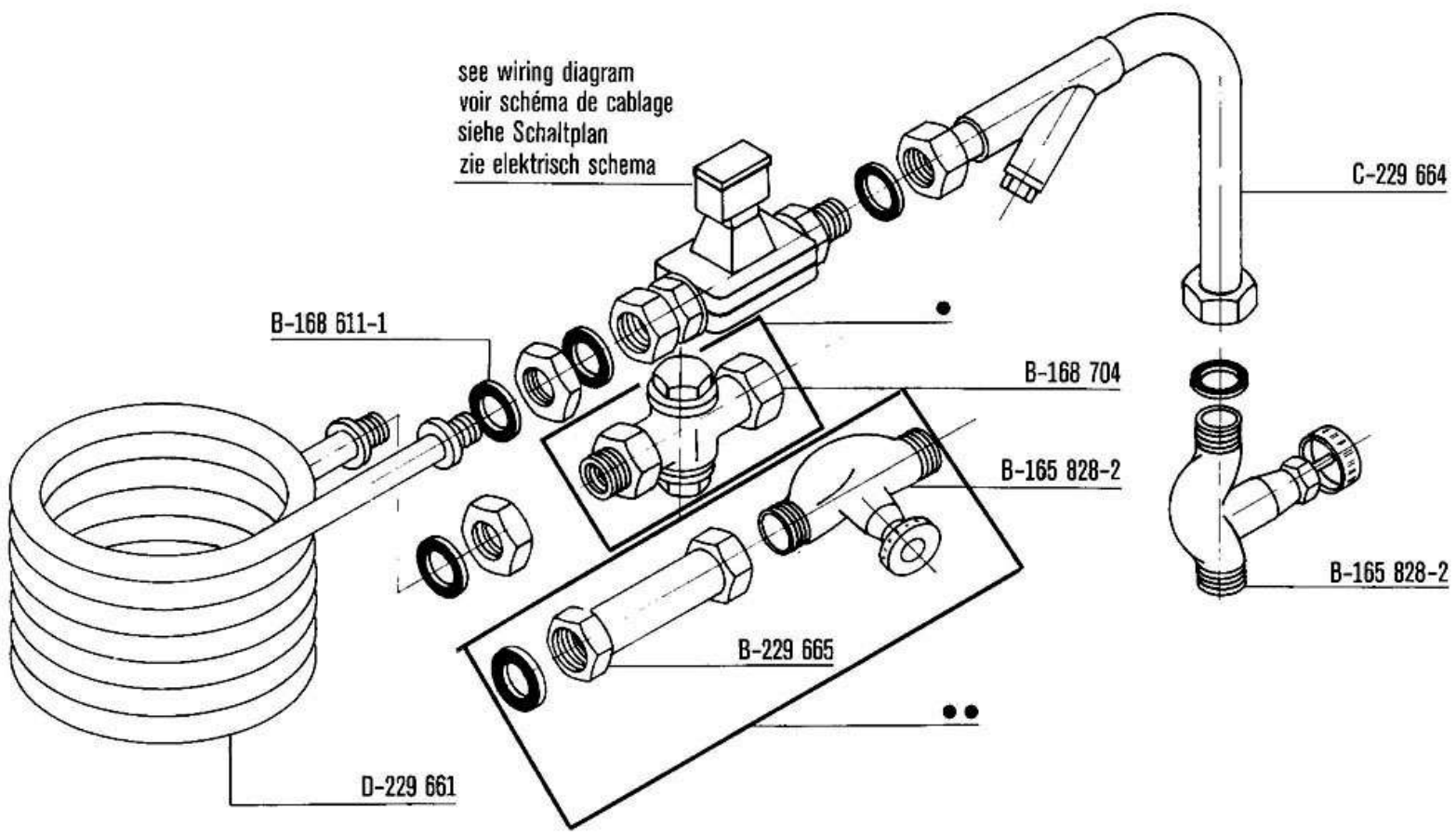

- steam
vapeur
Dampf
stoom
- hot water
eau chaude
Heißwasser
heet water

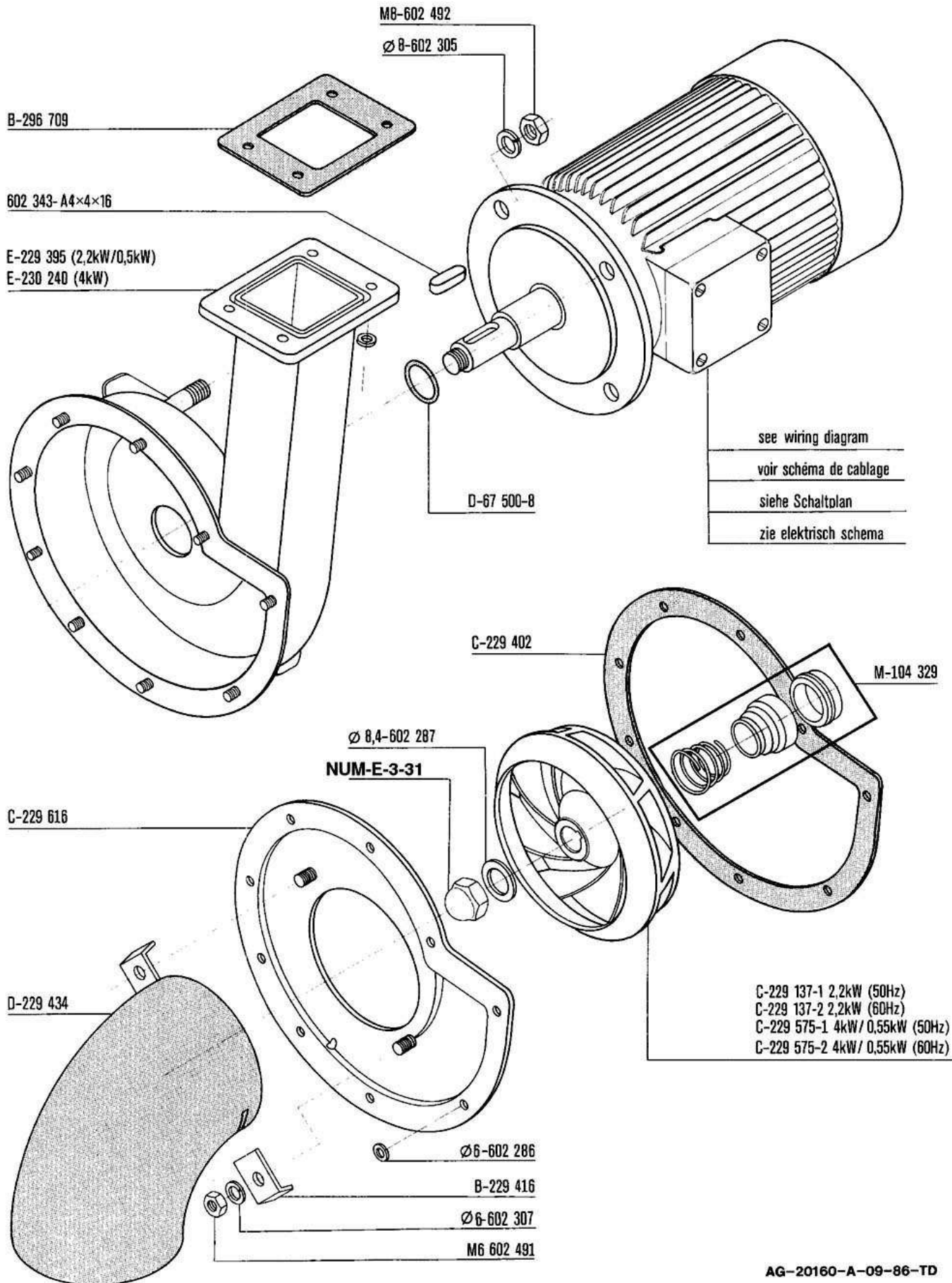
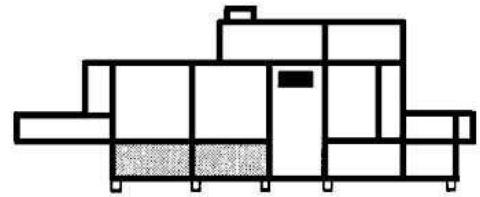

see wiring diagram
 voir schéma de cablage
 siehe Schaltplan
 zie elektrisch schema

C-229 137-1 2,2kW (50Hz)
C-229 137-2 2,2kW (60Hz)
C-229 575-1 4kW / 0,55kW (50Hz)
C-229 575-2 4kW / 0,55kW (60Hz)

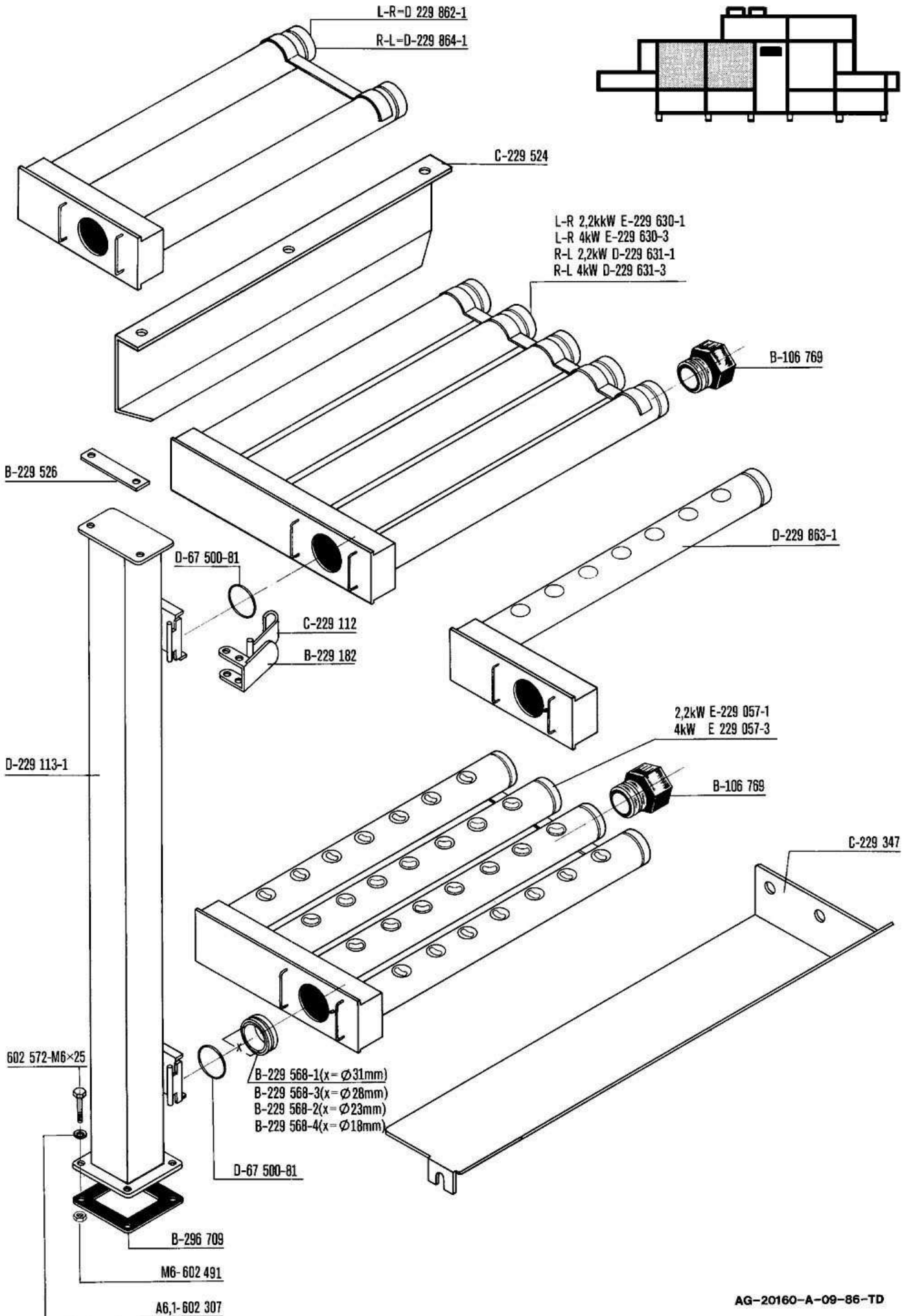
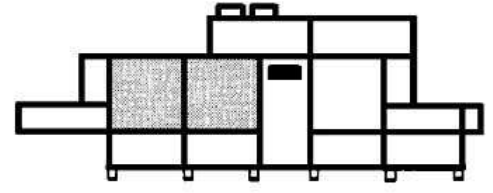

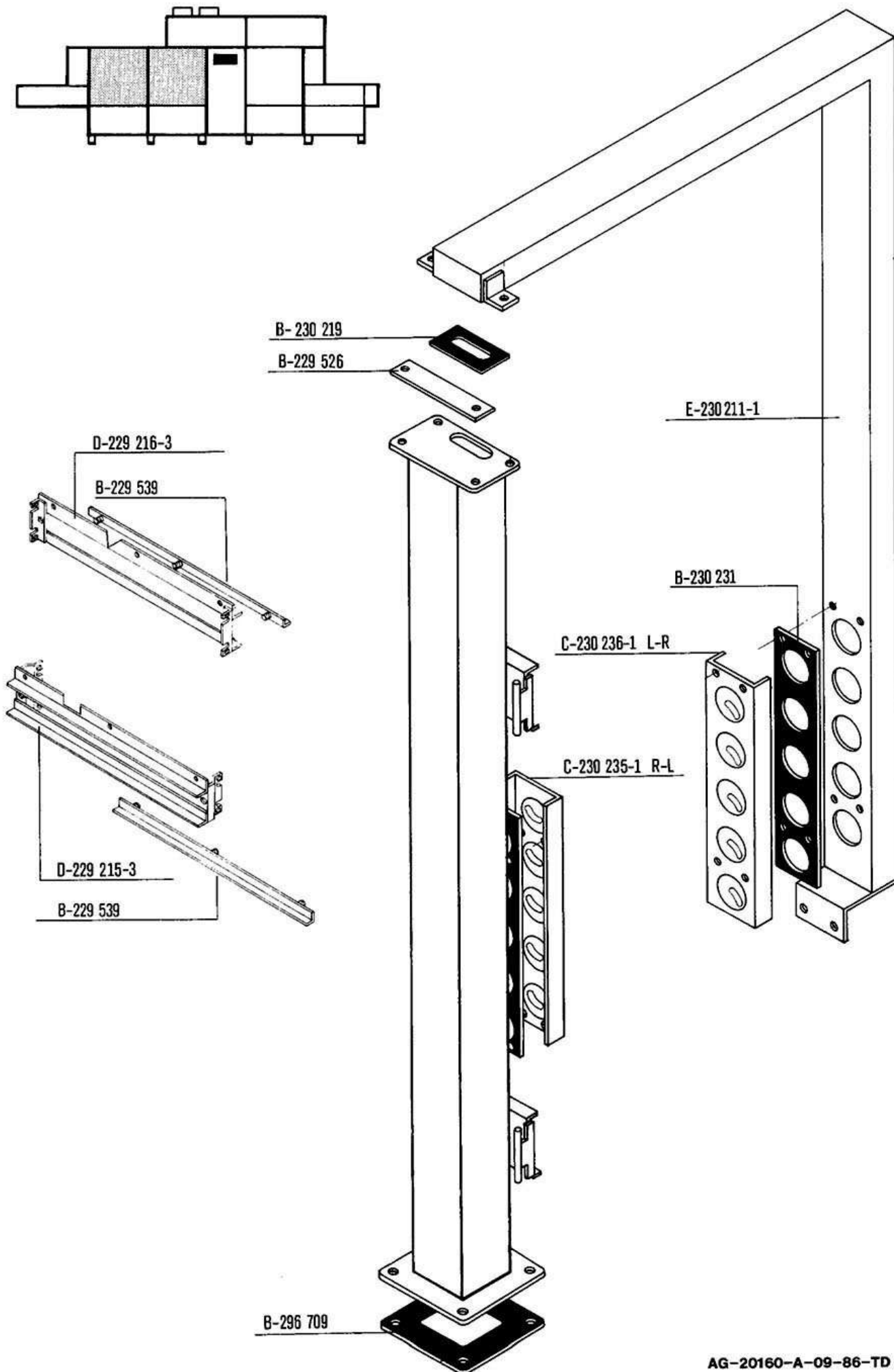

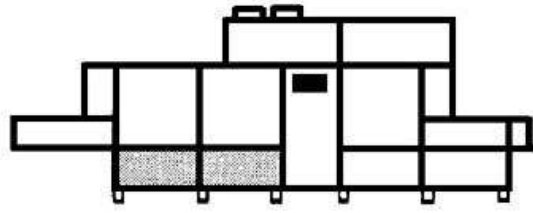

A+B+C

L-S

229427-1

230346

D-67 500-15

B-226 558-1

B-226 556

C-229 679-1

D-229 419

B-229 680-1

B-229 681-1

C-229 394

B-230 039

B-229 566

B-229 153

C-229 155

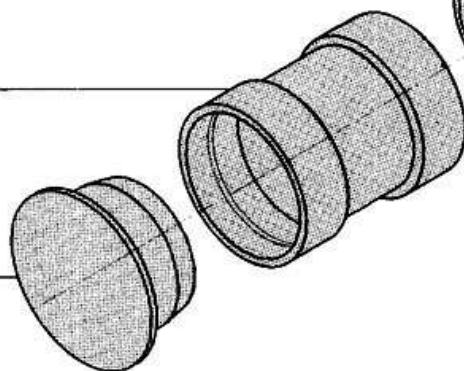
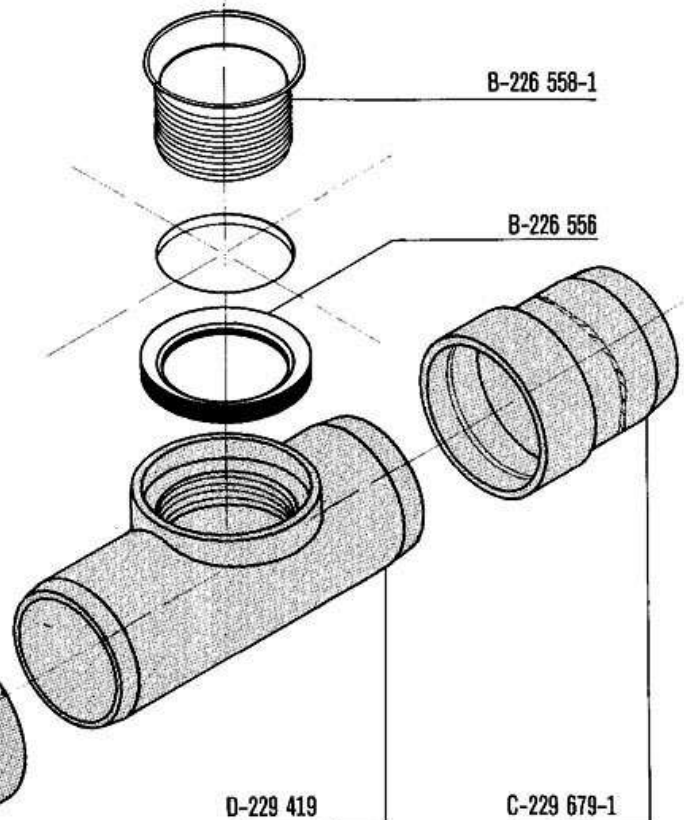
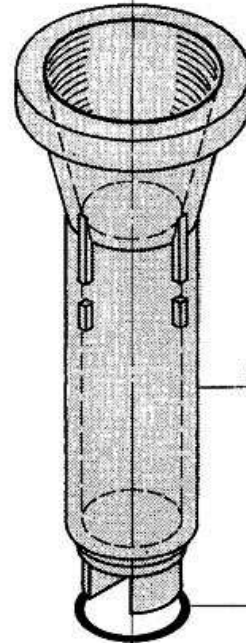
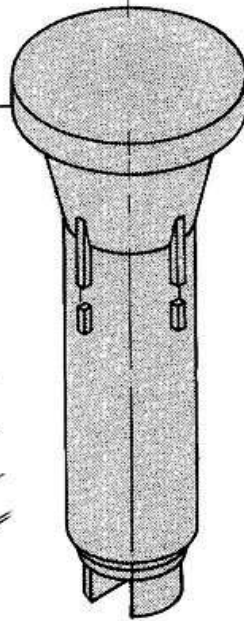
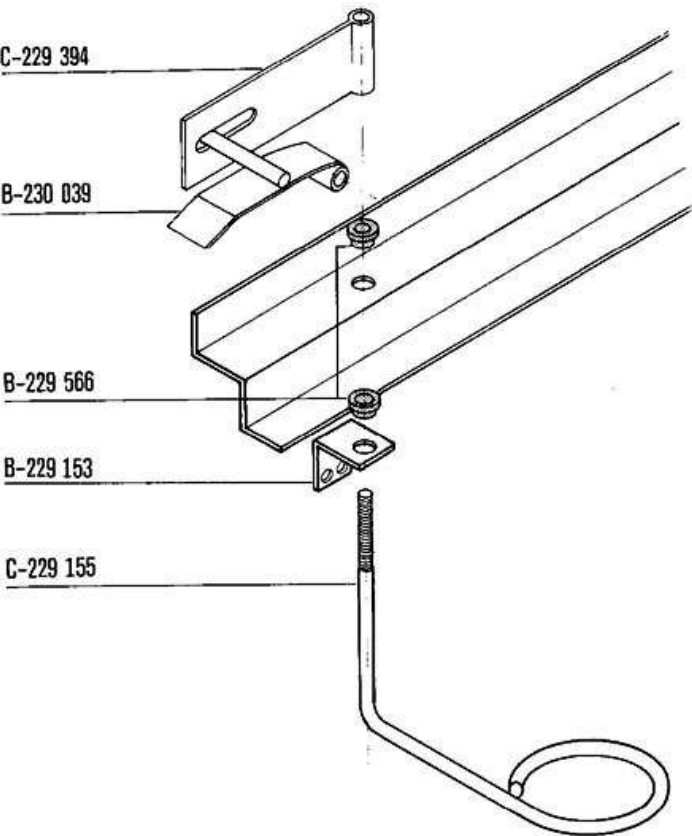

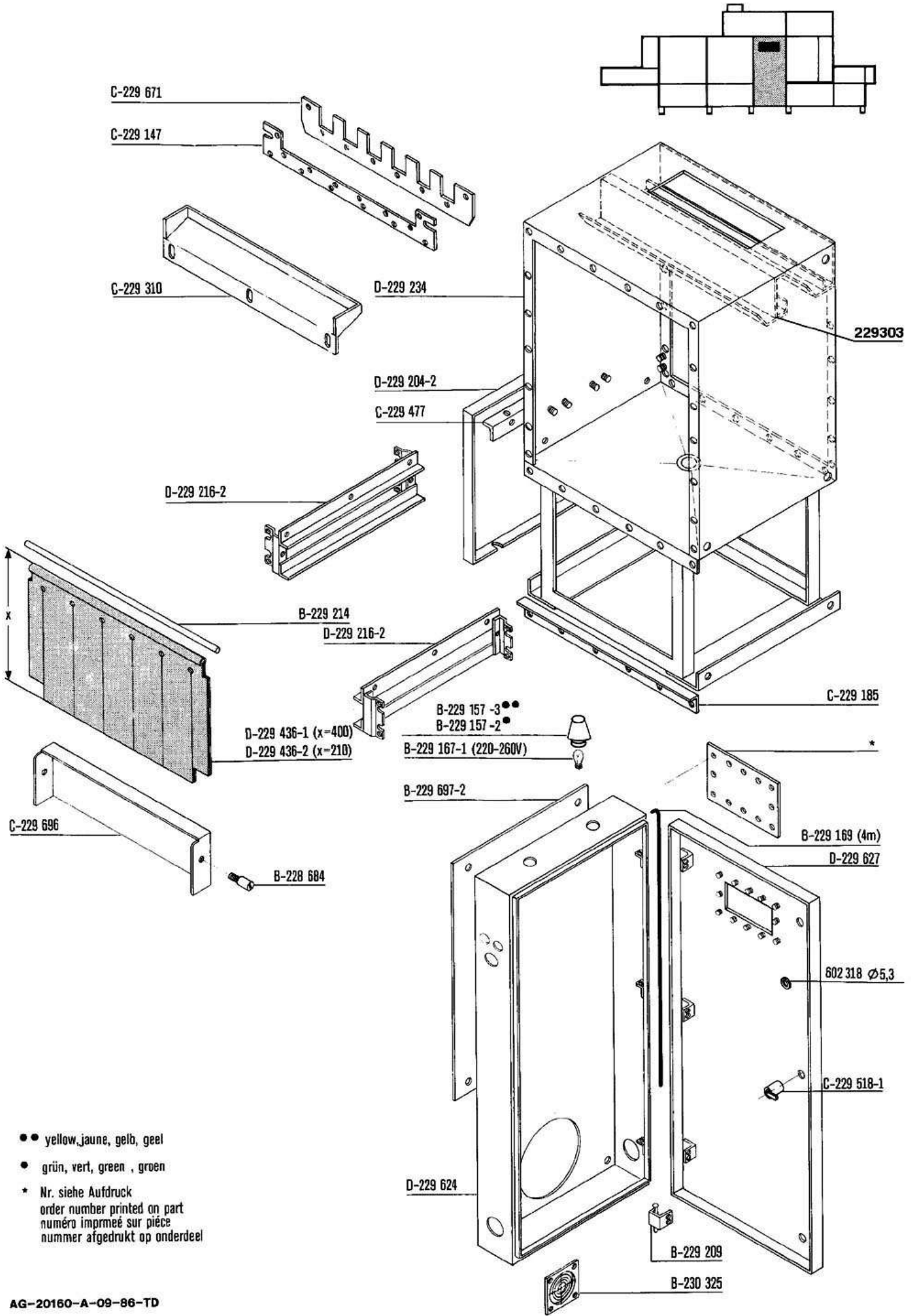

- yellow, jaune, gelb, geel
- grün, vert, green, groen
- * Nr. siehe Aufdruck
 order number printed on part
 numéro imprimé sur pièce
 nummer afgedrukt op onderdeel

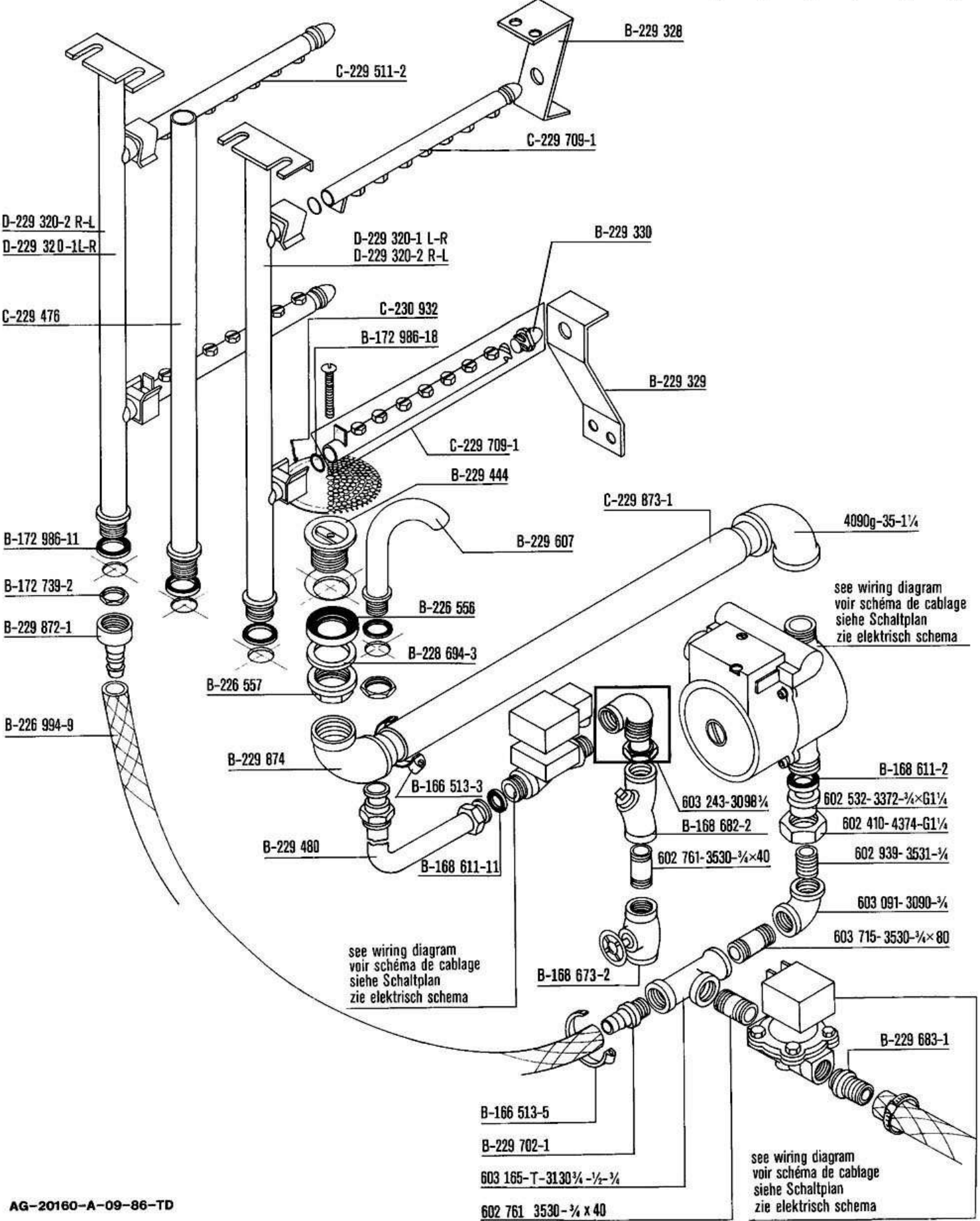
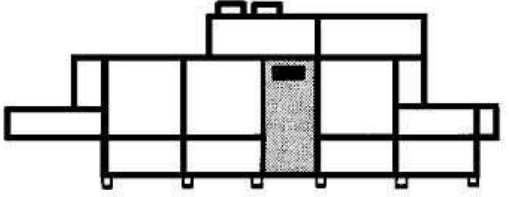

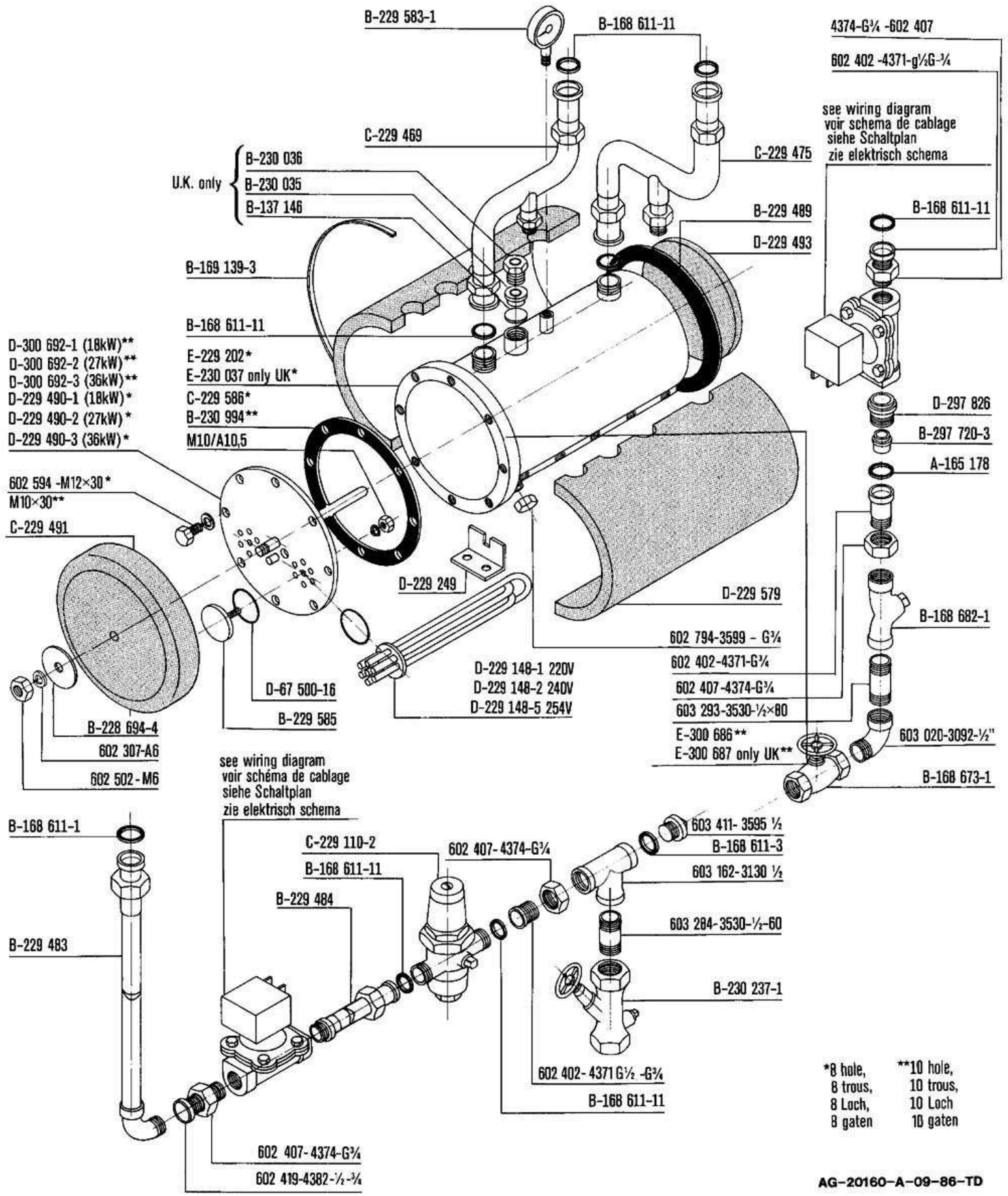
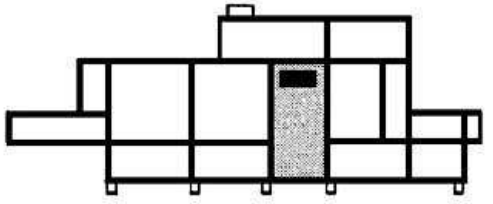

*8 hole,
 8 trous,
 8 Loch,
 8 gaten

**10 hole,
 10 trous,
 10 Loch
 10 gaten

HOBART

Booster 1.0 m² hot water + steam
Chaudiere 1.0 m² eau chaude + vapeur
Durchlauferhitzer 1.0 m² HW + Dampfbeheizt
Booster 1,4 m² heet water + stoom verwarming

FTX

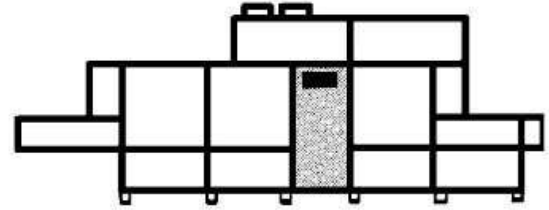

see wiring diagram
voir schéma de cablage
siehe Schaltplan
zie elektrisch schema

B-168 611-1

C-229 664

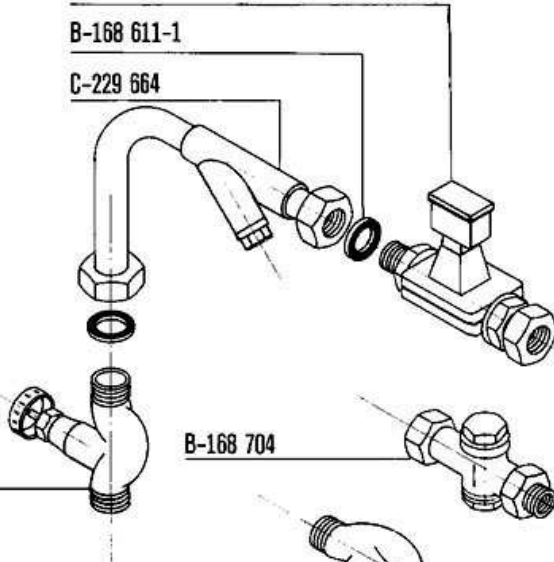

B-165 828-2

B-165 828

B-229 665

B-168 704

C-229 725

B-168 611-1

C-229 726

STEAM BOOSTER ASSY, 300702

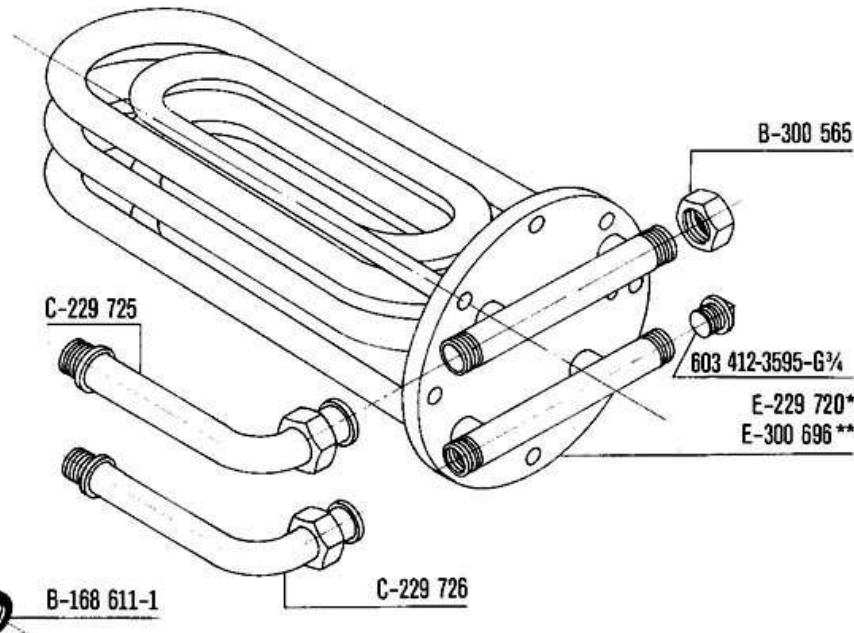

B-300 565

603 412-3595-G 3/4

E-229 720*

E-300 696**

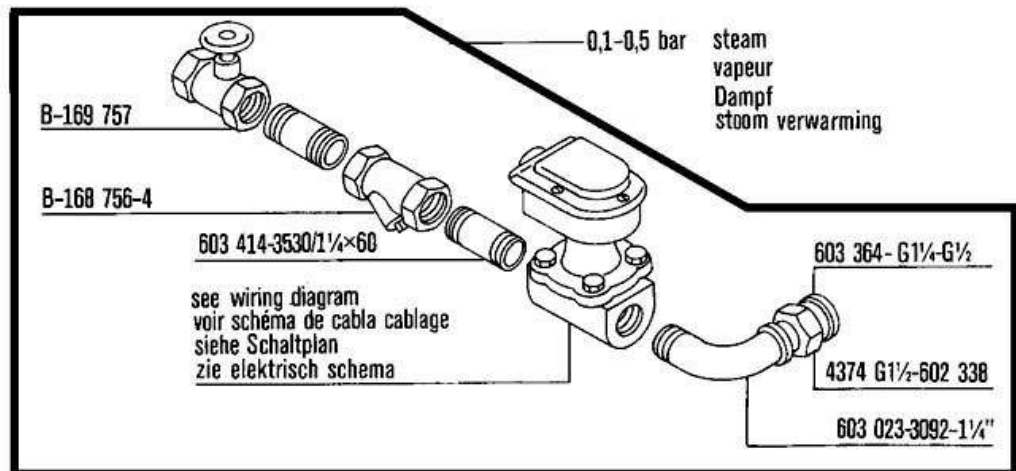

0,1-0,5 bar

steam
vapeur
Dampf
stoom verwarming

B-169 757

B-168 756-4

603 414-3530/1 1/4 x 60

see wiring diagram
voir schéma de cablage
siehe Schaltplan
zie elektrisch schema

603 364-G 1 1/4-G 1 1/2

4374 G 1 1/2-602 338

603 023-3092-1 1/4"

* 8 hole,
8 trous,
8 Loch,
8 gaten

** 10 hole,
10 trous,
10 Loch,
10 gaten

AG-20160-A-09-86-TD

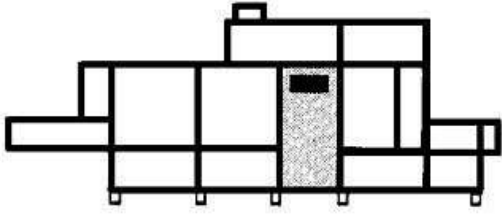

D-229 707

B-168 611-15

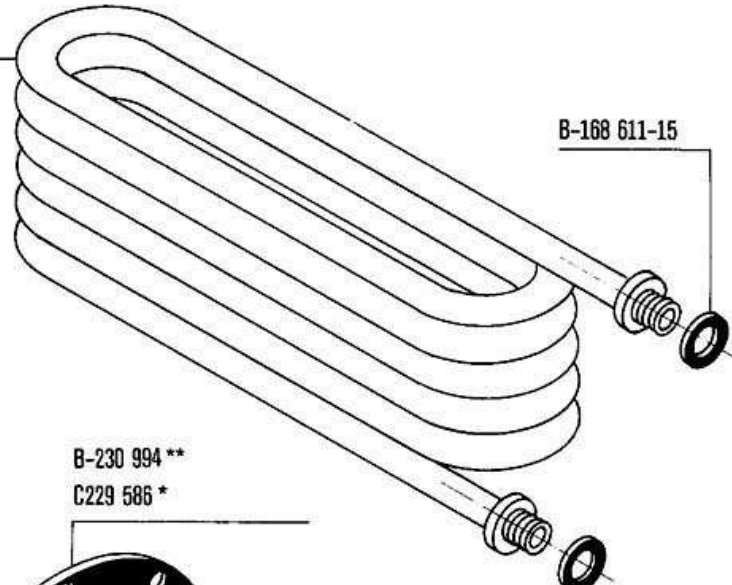

B-230 994**
 C229 586 *

B-168 611-1

B-300 694**
 B-230 657*

see wiring diagram
 voir schema de cablage
 siehe Schaltplan
 zie elektrisch schema

C-229 713-2

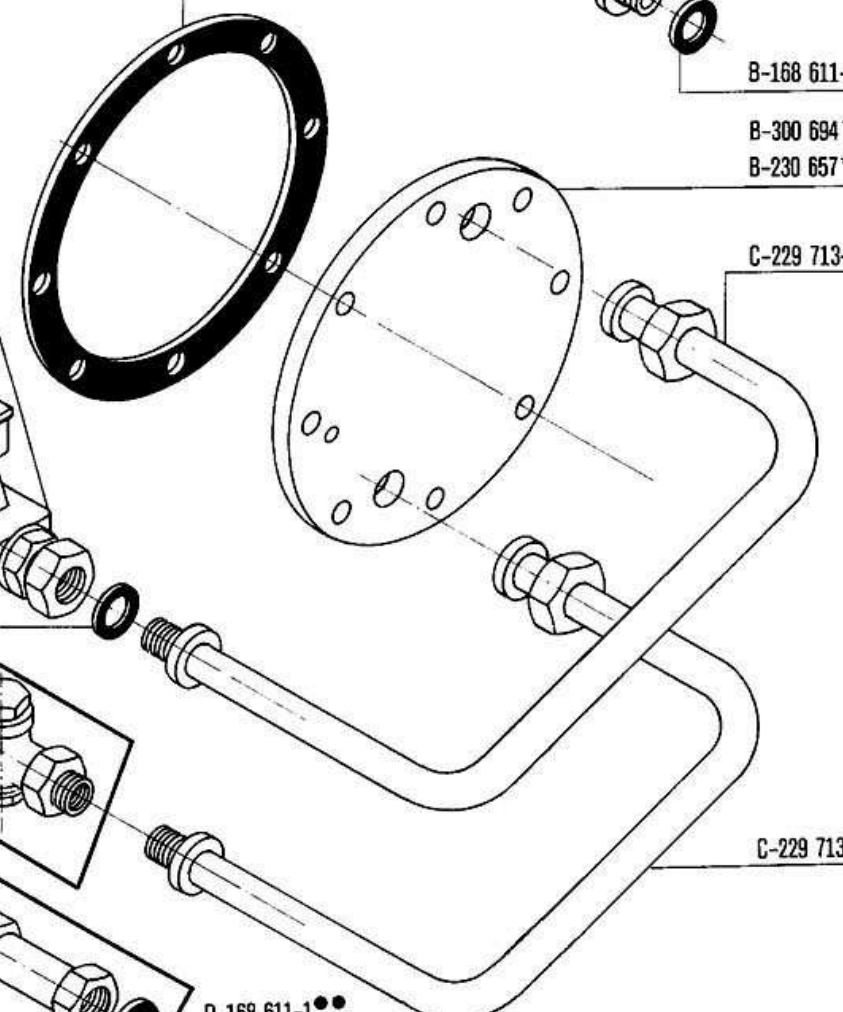

C-229 713-1

C-229 664

B-168 611-1

B-165 828-2

B-168 704 *

B-165 828-2 **

B-229 665 **

O-168 611-1 **

* 8 hole
 8 trous
 8 Loch
 8 gaten

** 10 hole
 10 trous
 10 Loch
 10 gaten

● steam
 vapeur
 Dampf
 stoom

●● hot water
 eau chaude
 Heißwasser
 heet water

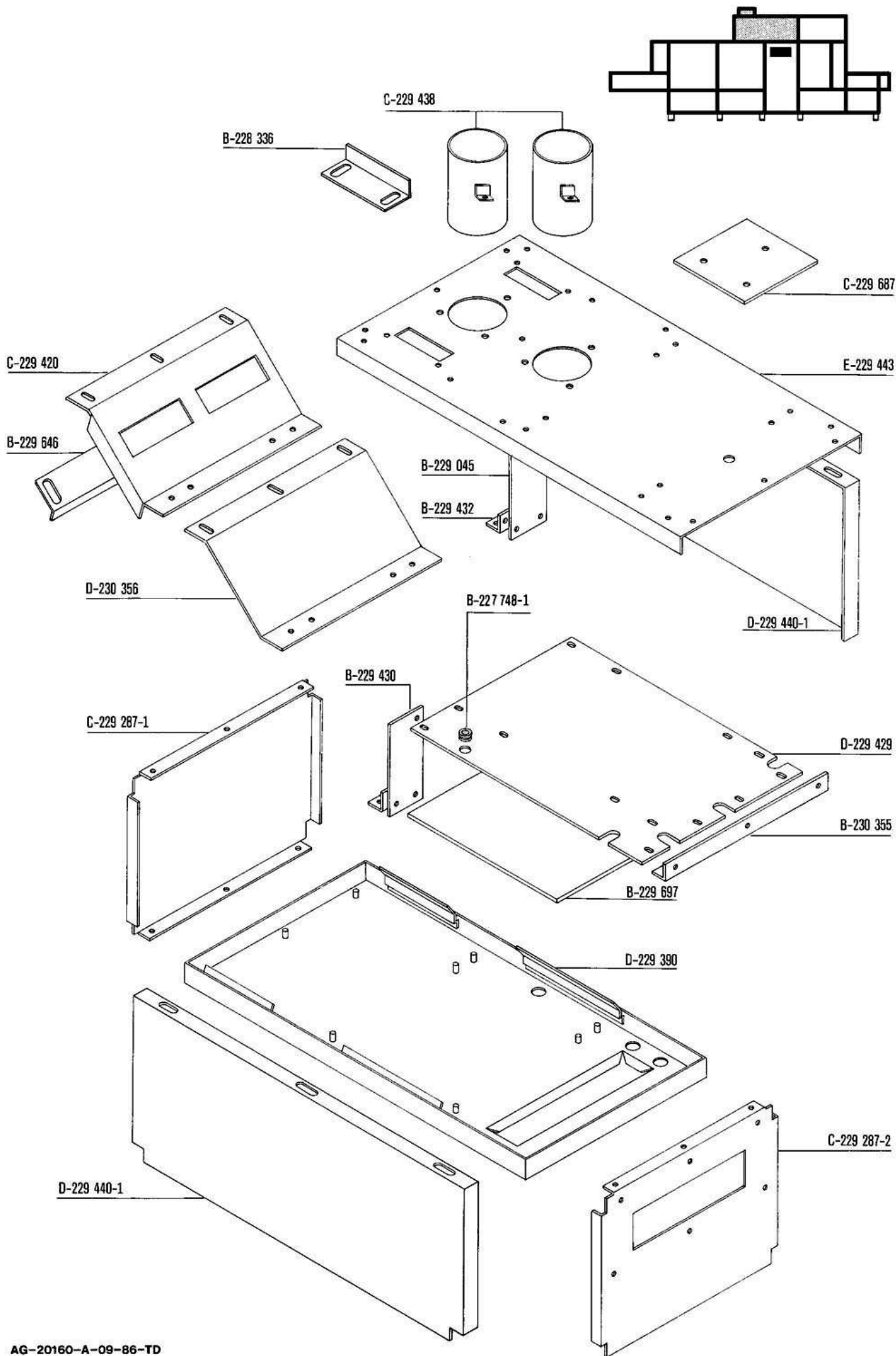

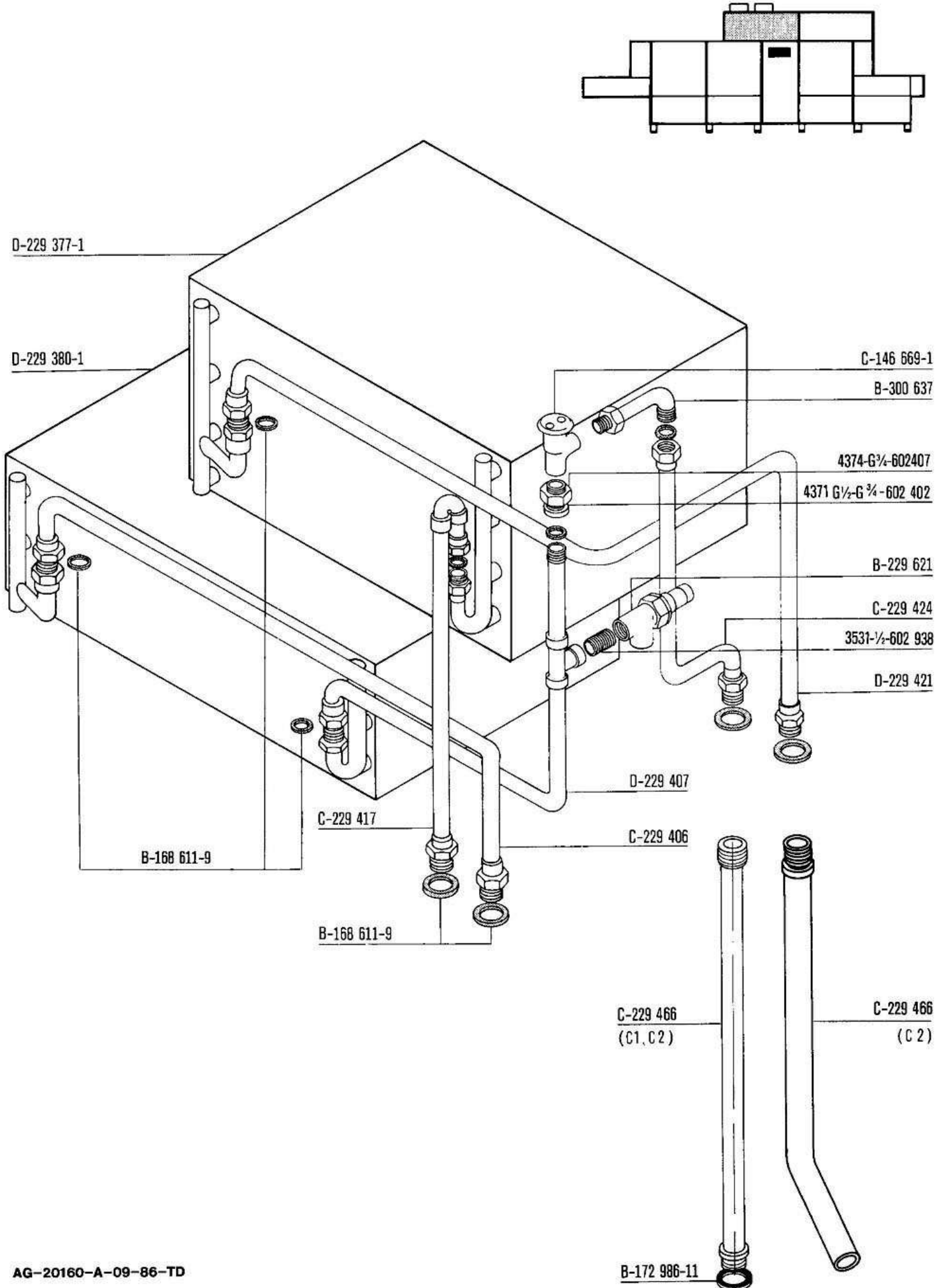

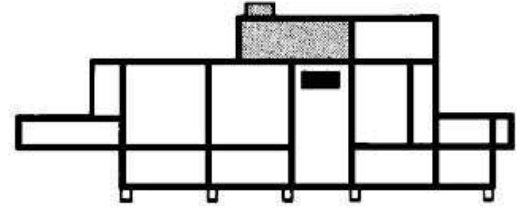

C-229 438

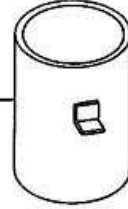

D-229 694

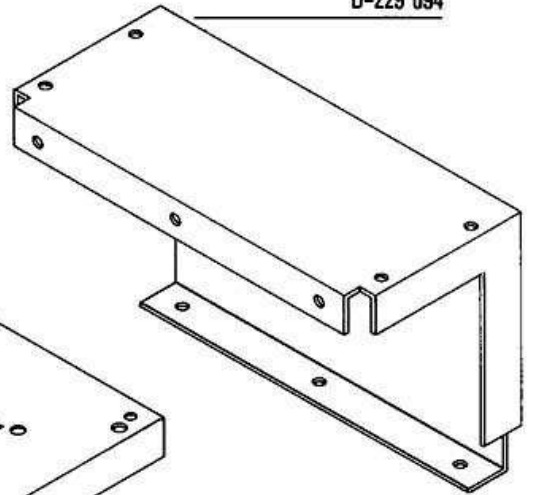

B-228 336

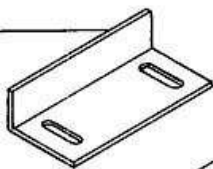

E-229 943

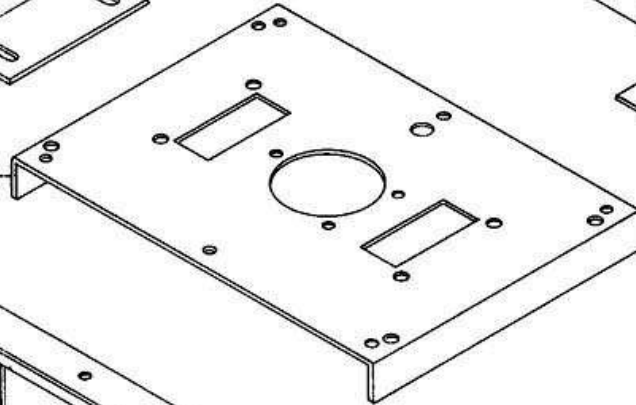

C-229 287-2

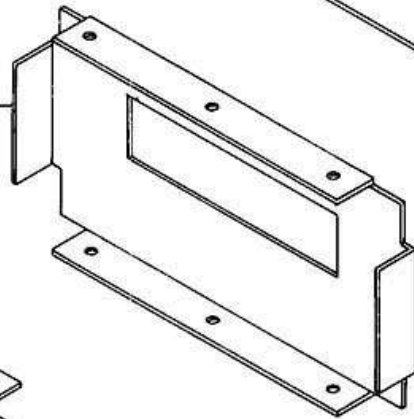

C-229 691

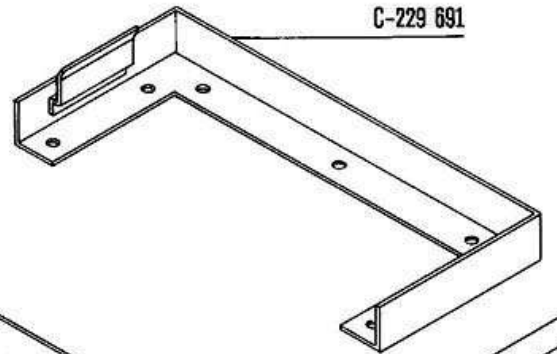

C-229 287-1

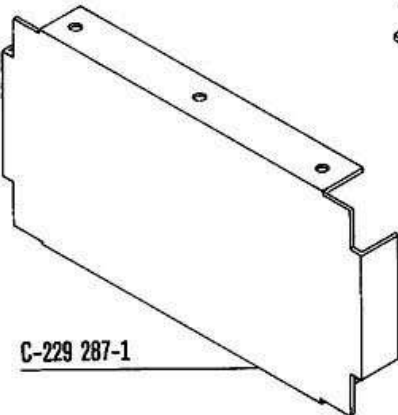

C-229 951

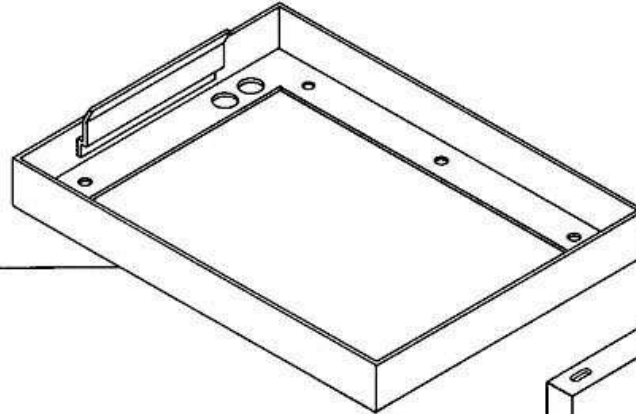

D-229 440-3

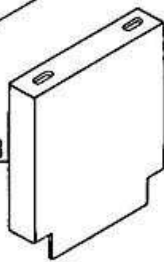

D-229 440-4

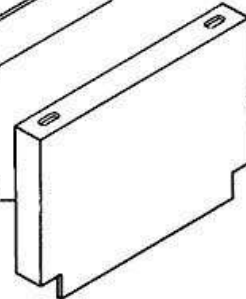

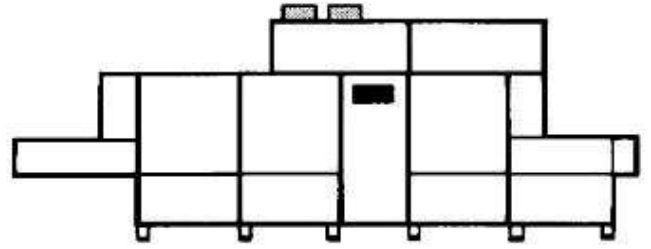

602 660 - M6x16

602 286 \varnothing 6,4

M-38934-2

see wiring diagram
voir schéma de cablage
siehe Schaltplan
zie elektrisch schema

B 5x5x25

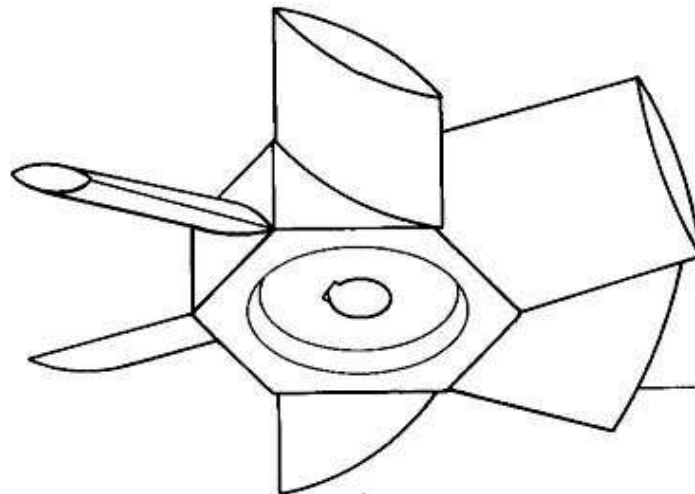
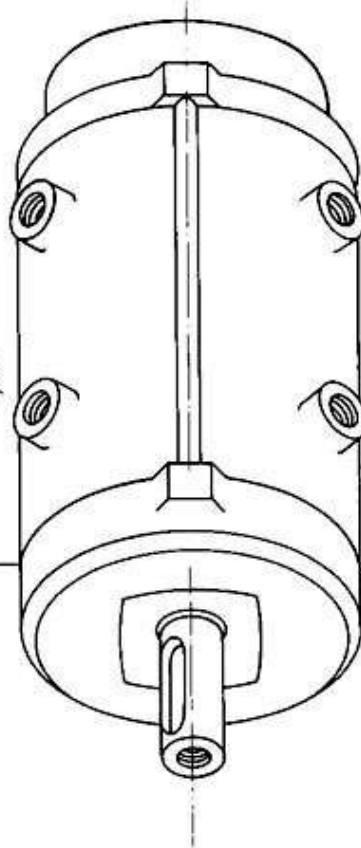

D-38933-9 (50Hz) \varnothing 236
D-38933-2 (60Hz)
D-38933-10 (50Hz) \varnothing 296
D-38933-11 (60Hz)

A6,4-602 286

602 570 - M6x16

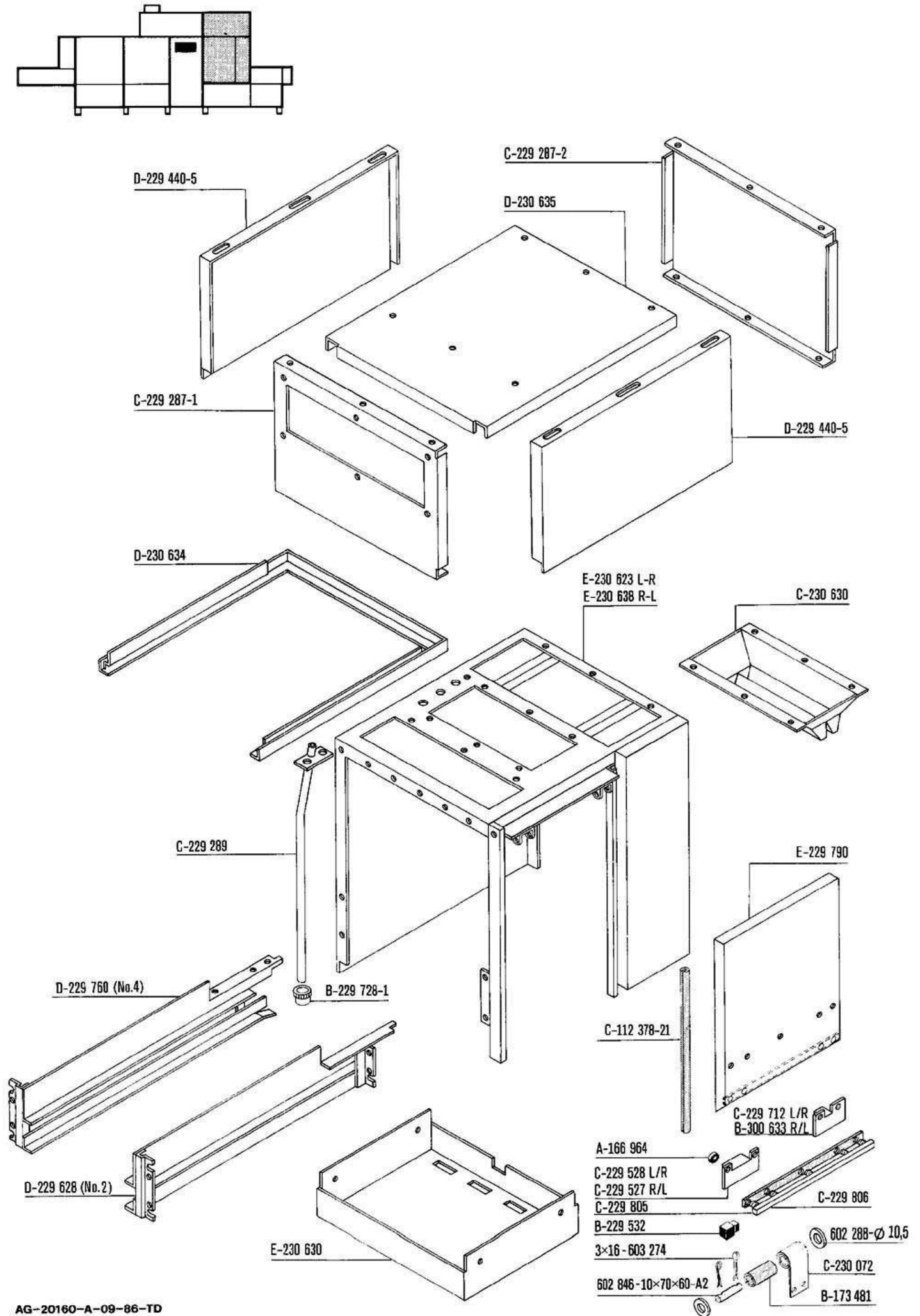

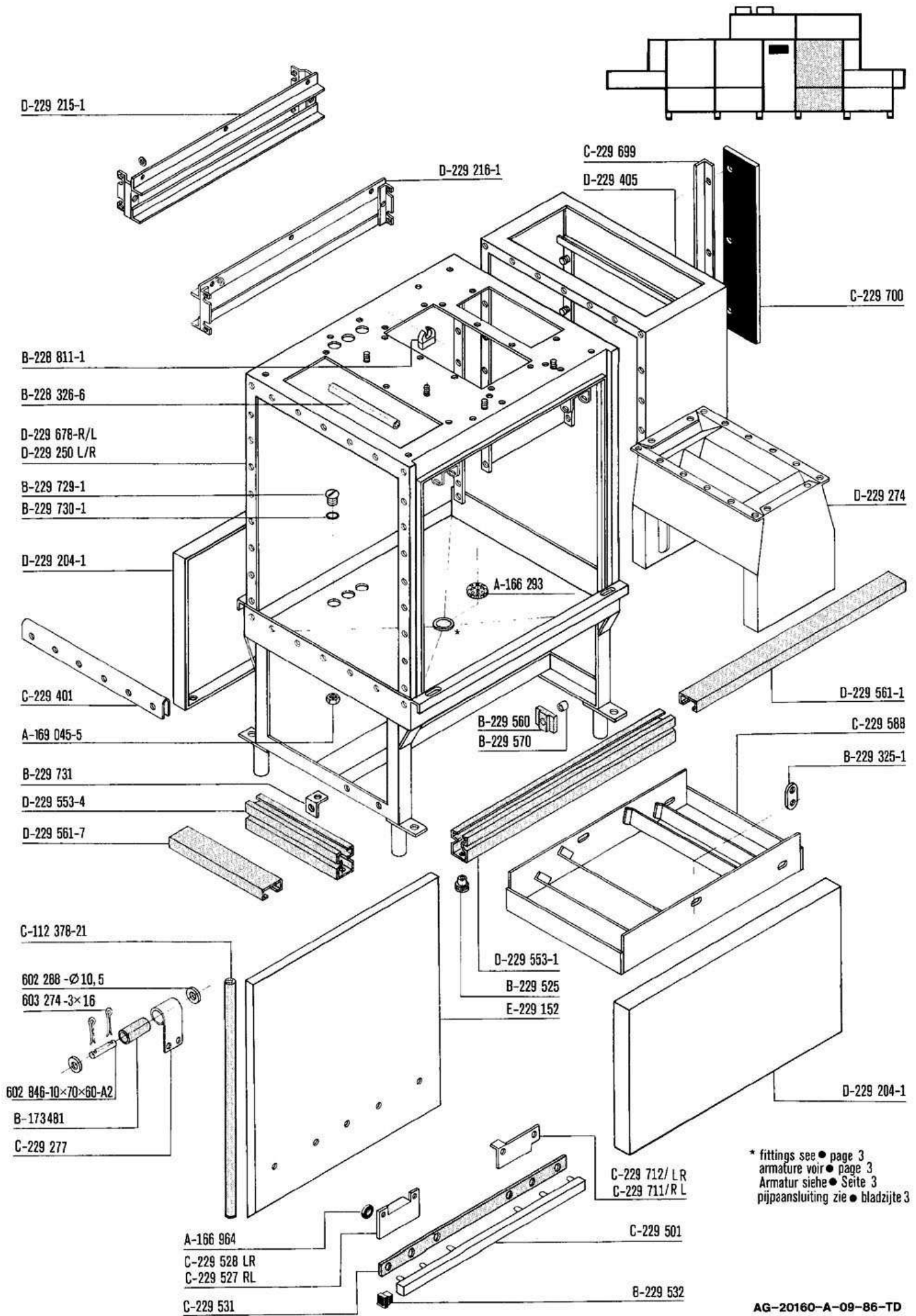

* fittings see ● page 3
armature voir ● page 3
Armatur siehe ● Seite 3
pijpaansluiting zie ● bladzijte 3



Drier - panel
Séchage - panneau
Trocknung - Verkleidung D2
Droogzône - bekleding

FTX

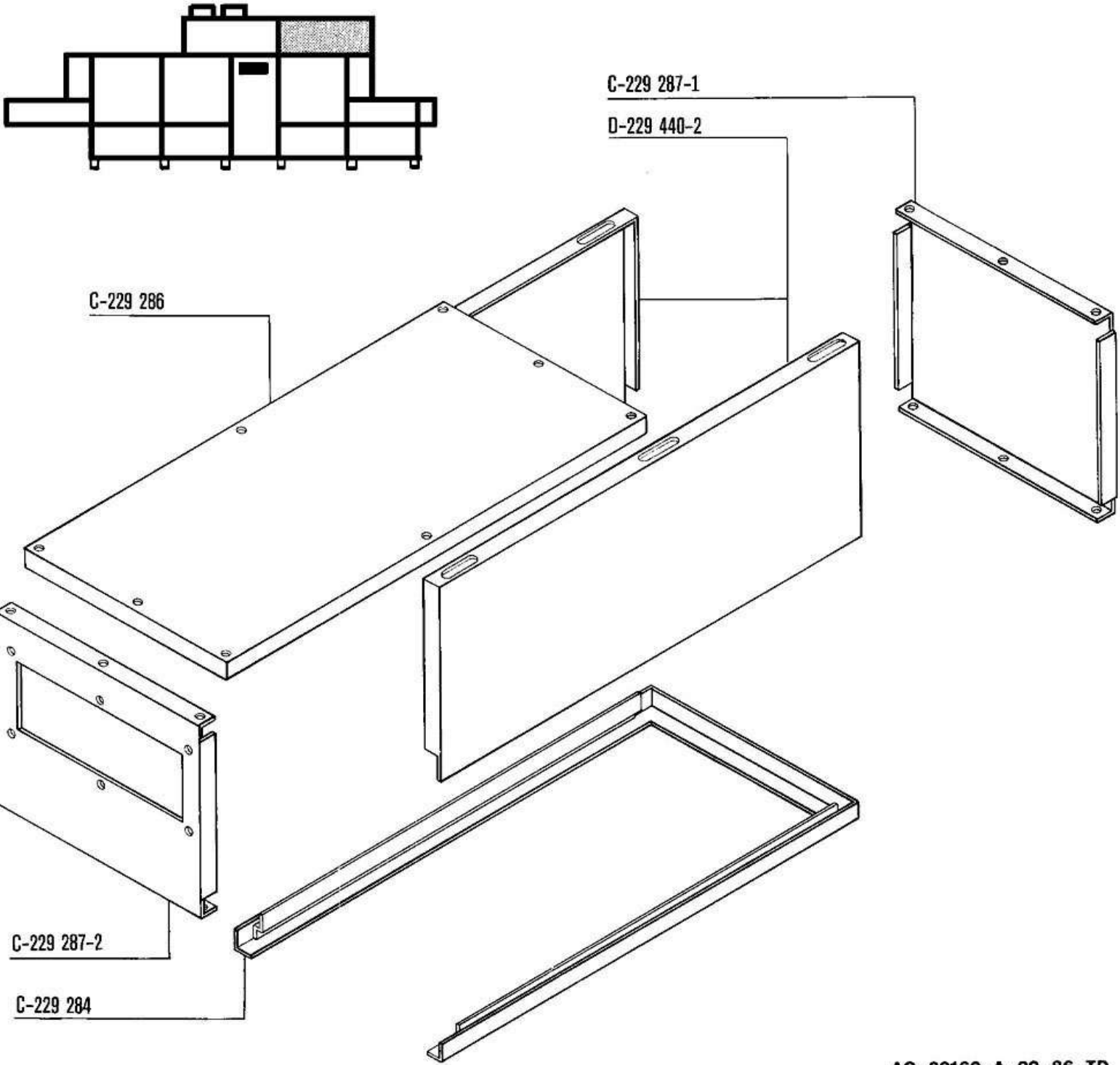

HOBART

Drier D1+D2-Pipework
Séchage D1+D2-tuyauterie
Trocknung D1+D2-Ventilleitung
Droging D1+D2-Magneetklep

FTX

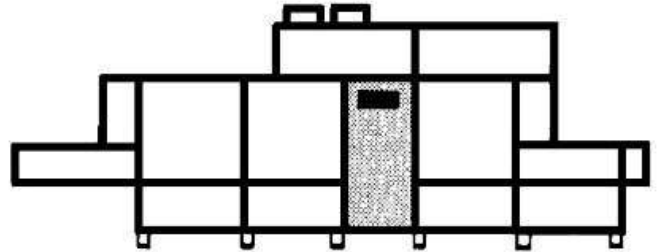

see wiring diagram
voir schéma de cablage
siehe Schaltplan
zie elektrisch schema

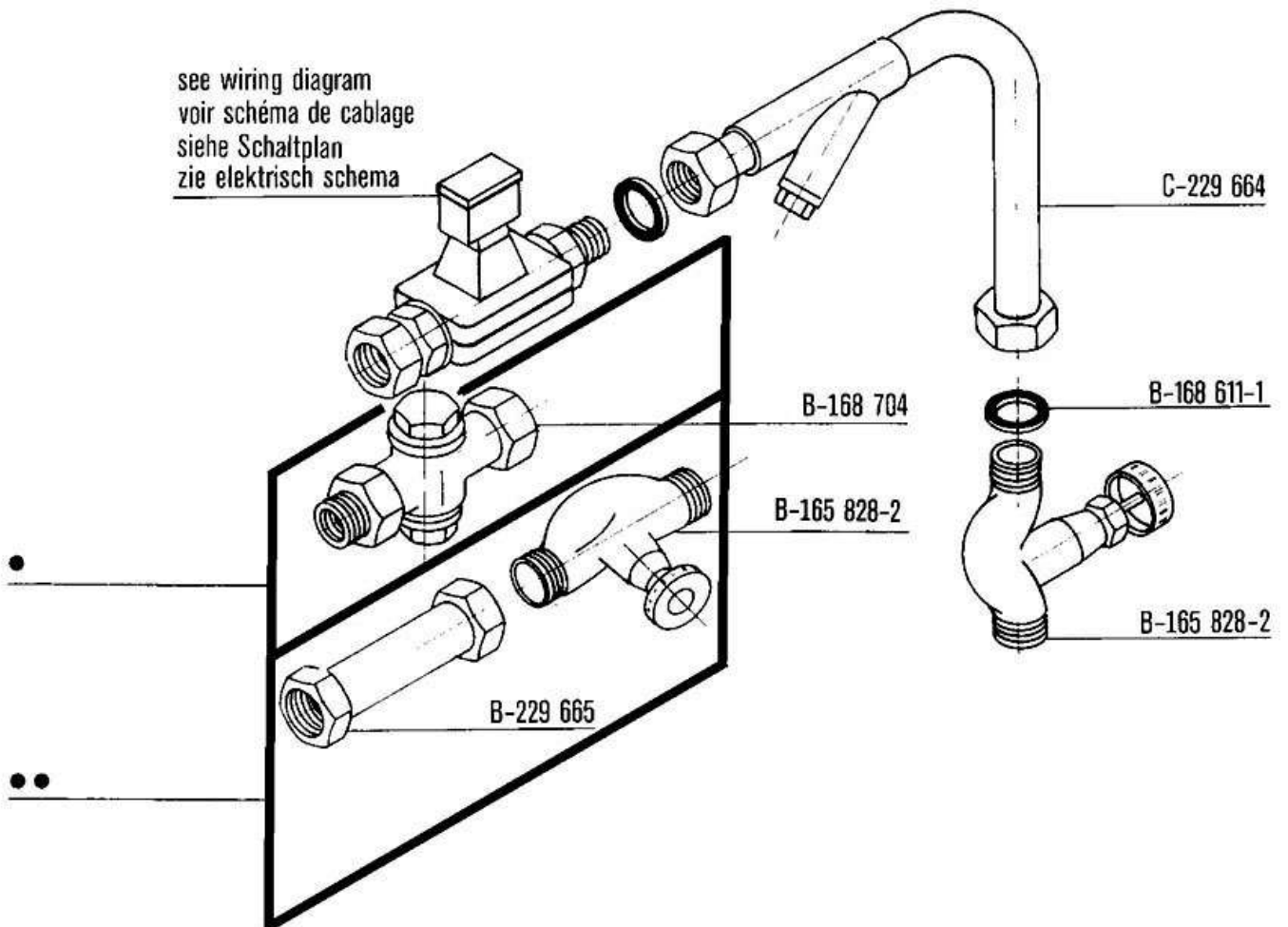

● steam
vapeur
Dampf
stoom

●● hot water
eau chaude
Heißwasser
heet water

AG-20160-A-09-86-TD

* see wiring diagram
 voir schéma de cablage
 siehe Schaltplan
 zie elektrisch schema

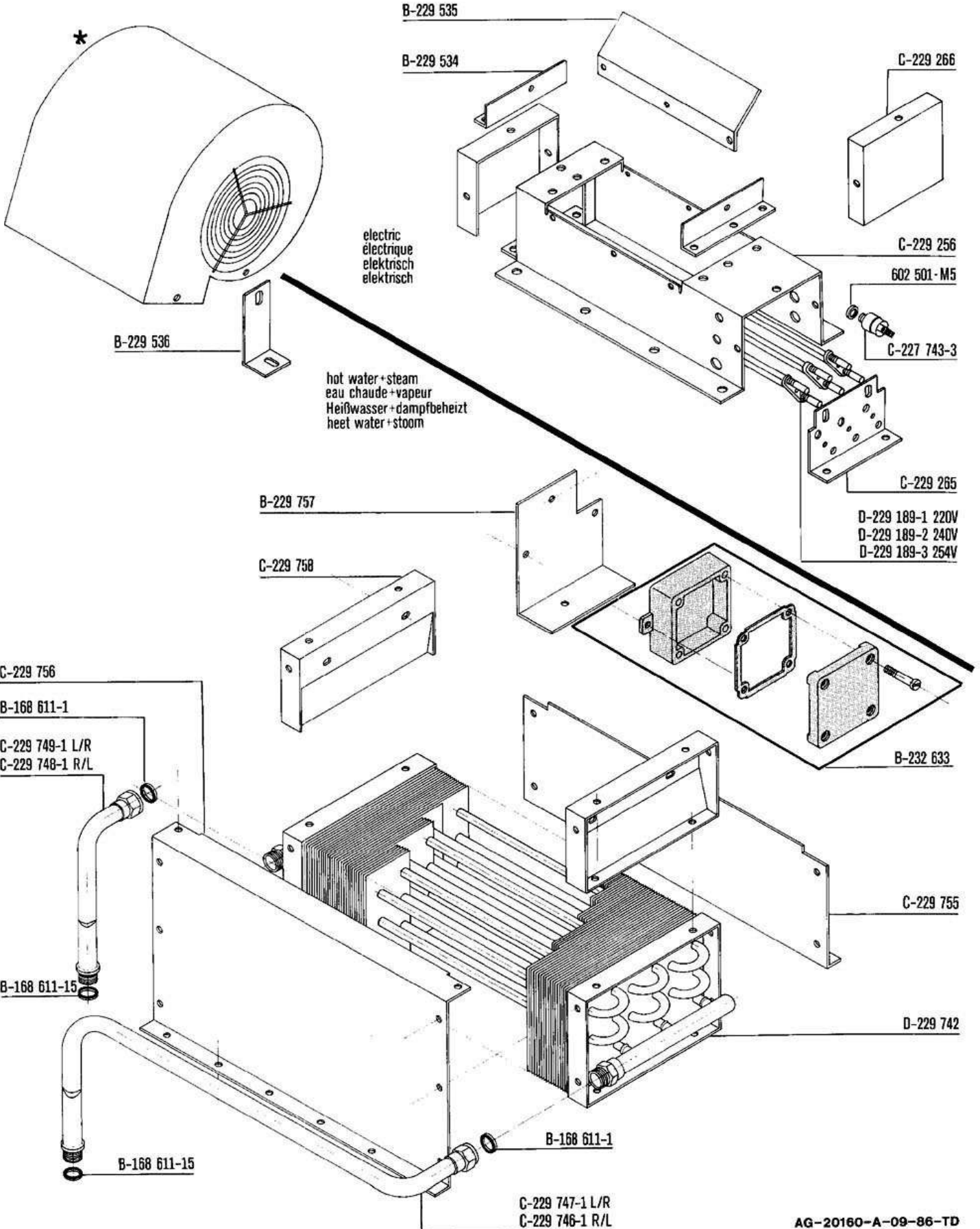
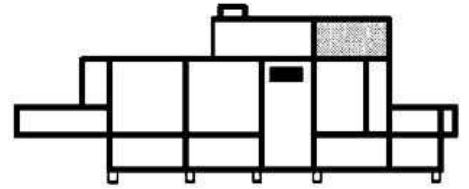

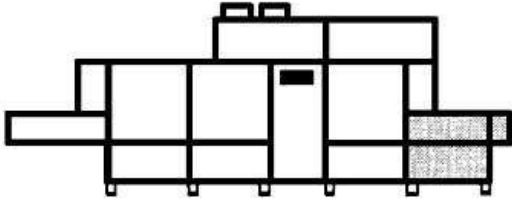

- C-229 544-2 (w=584)
- C-229 544-3 (w=884)
- C-229 544-5 (w=1414)
- C-229 544-6 (w=114)

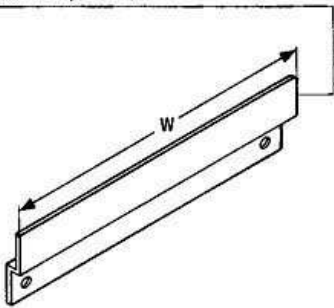

D-229 339

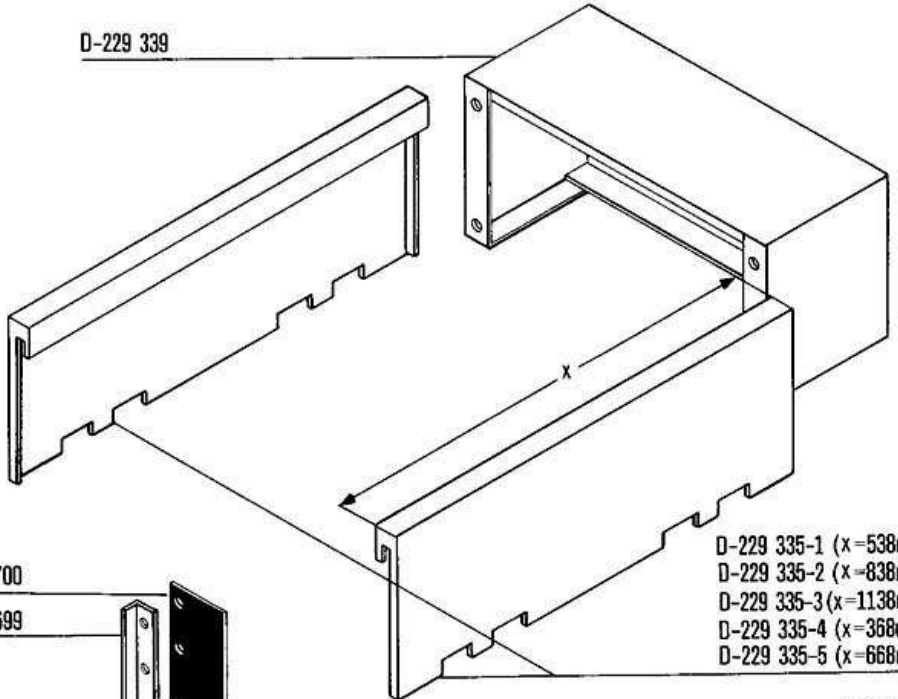

- D-229 335-1 (x=538mm)
- D-229 335-2 (x=838mm)
- D-229 335-3 (x=1138mm)
- D-229 335-4 (x=368mm)
- D-229 335-5 (x=668mm)

C-229 700

C-229 699

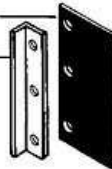

M-102 312

D-229 344

D-229 405

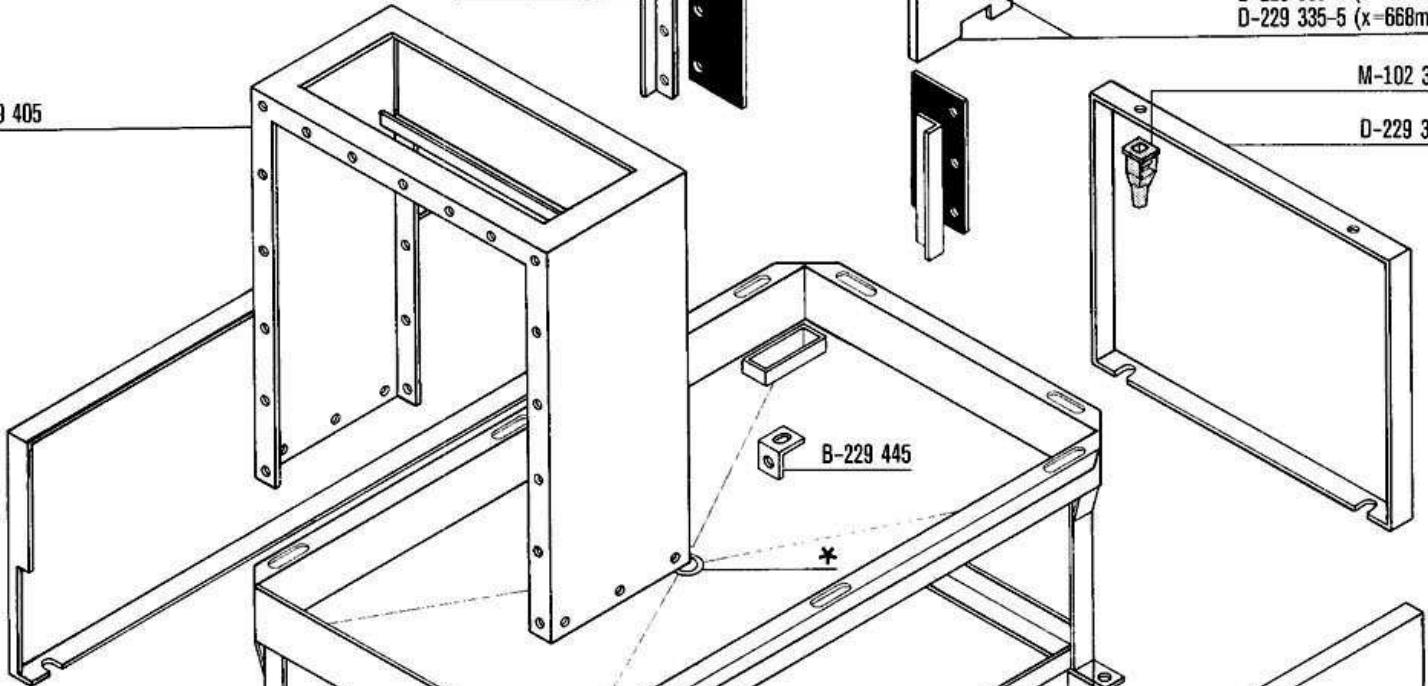

B-229 445

- D-229 352-1 (900mm)
- D-229 352-2 (1200mm)
- D-229 352-3 (1500mm)

* fittings see ● page 3
armature voir ● page 3
Armatuur siehe ● Seite 3
pijpaansluiting zie ● bladzijte 3

- D-229 204-1 (z=900mm)
- D-229 204-3 (z=1200mm)
- D-229 204-4 (z=1500mm)

B-229 525

